

# RAILROAD RIGHT OF WAY

DOCUMENT(S) WILL BE SCANNED  
AT A LATER TIME

RECORDED RIGHT OF WAY NO. R 3 1858

**Detroit  
Edison**

To: Records Center

September 7, 1978

From: Doreen McLain  
Real Estate and Rights of Way Department

Subject: Distribution R/W crossing the Chesapeake & Ohio R.R.,  
City of Detroit, Wayne County, RX-3787A

The attached papers are for records center storage. Information about the completed transaction is shown in the following summary.

R.R. 1	R.R. INVOICE NO. M.P.S.C. NO. OR R.E. & RW NO. 3	Update Type 10	DECO RECORDS CENTER FILE NO. 15	R.X. NO. OR MAP NO. 20	Facility 21	Agreement Date 22
02	9999101	1		3787A	1	072578

Payment Frequency 23	Rental 33	OH-UG Code 34	Division 35	County 36	City or Township 38	Section 39
X	00000	1	2	13	DETROIT	

Location 47		50
IN P P 380' SE OF FIRE MAN 4850' NE OF LIVERN		

Update Type Codes  
1 = New Agreement  
2 = Revised Agreement  
3 = Terminated Agreement

The Accounts Payable Department is requested to start or change the rental payment effective

Approved: *Alan A. Chelotova*

- cc:  Accounts Payable  
 Service Planning S. TOROK  
 System Engineering  
 Transmission & Distribution

RECORDED RIGHTS OF WAY NO. 31858

August 21, 1978

Mr. Bruce Bordner, Office Engineer  
Michigan Dept. of State  
Highways & Transportation  
P.O. Box 1226  
18101 Nine Mile Road  
Southfield, MI 48075

Gentlemen:

The Detroit Edison Company plans to construct, operate,  
and maintain an overhead line in the City of Detroit,  
Wayne County.

The line will cross the tracks of the Chesapeake  
& Ohio Railroad. The wires to be installed  
are:

Span B-C  
Three 1/0 ACSR 4,800 volts  
One 4A2T 120 volts

The railroad has given the following waiver of hearing:

Waiver dated 7/25/78 enclosed  
 Blanket Waiver on file with the MPSC.

The proposed crossing is shown on drawing No. RX-3787A

This is a new crossing.  
 This is a re-construction.

Please grant a State Highway Permit to the Detroit Edison  
Company for the proposed crossing.

DO NOT WRITE IN THIS BOX		
Application No.	82000-46-78	
Permit No.	ME-501-RR-78	
Date of Issuance	Aug. 25, 1978	
Fee Amount	Date	
Exempt		
Cash	Bill	By CLC

By:   
District Utilities-Permits Engr.

Very truly yours,

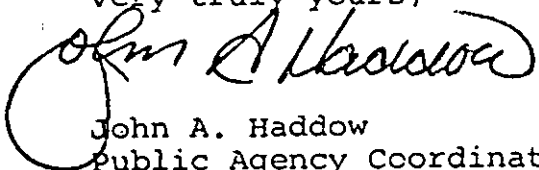

John A. Haddow  
Public Agency Coordinator  
Real Estate & Rights of Way

RECORDED RIGHT OF WAY NO. 31858

Edison

2000 Second Avenue  
Detroit, Michigan 48226  
(313) 237-8000

July 20, 1978

The Chesapeake & Ohio Railroad  
P.O. Box 1800  
Huntington, West Virginia 25718

Proposed Overhead Wire Crossing:

Span B-C  
Three 170 ACSR 4,800 volts  
One 4A2T 120 volts

Station: Opp. 118 + 53  
Location: \_\_\_\_\_  
Sub-Division: West Detroit  
Division: Michigan  
M.P.S.C. Hearing Waived 7-25-78  
The Chesapeake and Ohio Railway Company  
*Robert*  
Chief Engineer-System  
Your File \_\_\_\_\_  
C. & O. File 131-A-2-2116

Specific Location

In private property approximately 380' SE of Tireman Ave.  
& 850' NE of Livernois, City of Detroit, County of Wayne

R. R. Valuation Station 118 + 53 R. R. Mile Post \_\_\_\_\_  
City/Village Detroit Township \_\_\_\_\_  
County Wayne Detroit Edison Plan Attached 3787A  
This is a New Crossing \_\_\_\_\_ This is a Reconstruction of Existing Crossing XX  
Previous Agreement Information (if any) Date May 5, 1966 (R. R. Plan) 131-4N-8340

RECORDED  
RIGHT OF WAY NO.  
31858

Blanket Waiver of Hearing Covers \_\_\_\_\_ Waiver of Hearing Requested (in duplicate) \_\_\_\_\_  
(Waiver of Hearing to be mailed to applicant listed below)

All construction will be done in accordance with the rules and regulations of the Michigan Public Service Commission.

*John A. Haddow*  
John A. Haddow  
Public Agency Coordinator

**Detroit Edison**

2000 Second Avenue  
Detroit, Michigan 48226  
(313) 237-8000

July 20, 1978

The Chesapeake & Ohio Railroad  
P.O. Box 1800  
Huntington, West Virginia 25718

Proposed Overhead Wire Crossing:

Span B-C  
Three 1/0 ACSR 4,800 volts  
One 4A2T 120 volts

Specific Location

In private property approximately 380' SE of Tireman Ave.  
& 850' NE of Livernois, City of Detroit, County of Wayne

R. R. Valuation Station 118 + 53 R. R. Mile Post \_\_\_\_\_

City/Village Detroit Township \_\_\_\_\_

County Wayne Detroit Edison Plan Attached RX-3787A

This is a New Crossing \_\_\_\_\_ This is a Reconstruction of Existing Crossing XX

Previous Agreement Information (if any) Date May 5, 1966 (R. R. Plan) 131 4N 8340

Blanket Waiver of Hearing Covers \_\_\_\_\_ Waiver of Hearing Requested (in duplicate)  
(Waiver of Hearing to be mailed to applicant listed below)

All construction will be done in accordance with the rules and regulations of the Michigan Public Service Commission.

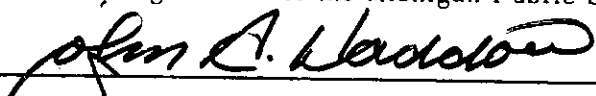
  
John A. Haddow  
Public Agency Coordinator

RECORDED RIGHT OF WAY NO.

31858

PROPOSED LINE CROSSING OVER CHESAPEAKE AND OHIO R.R.  
IN PR. PROPERTY APPROX. 280' SE OF TIREMAN AVE  
AND 850' NE OF LIVERNDIS AVE.

EXISTING PERMIT NUMBER ED2-8-5801

CITY OF DETROIT

SECTION \_\_\_\_\_ TOWNSHIP (DET. 180) T \_\_\_\_\_ R \_\_\_\_\_ COUNTY WAYNE

**NOTES**

MATERIALS SHALL BE AS NOTED IN THE DETROIT EDISON COMPANY'S GENERAL SPECIFICATIONS FOR OVERHEAD LINE CONSTRUCTION AT RAILROAD CROSSINGS DATED MARCH 1955.

ACTUAL FIELD DIMENSIONS MAY VARY SOMEWHAT FROM THOSE SHOWN BUT THE REQUIREMENTS OF ORDER NO. 1679 OF MICHIGAN PUBLIC SERVICE COMMISSION AS REVISED JAN. 1, 1944, WILL BE COMPLIED WITH

**MINIMUM CLEARANCES**

NEAREST POLE TO RAIL	SIDING	7 FT
	MAIN LINE	12 FT
WIRES OVER TRACKS	0 - 750 VOLTS	27 FT
	750 - 15,000 VOLTS	28 FT
	15,000 - 50,000 VOLTS	30 FT
WIRES OVER R R SIGNAL	0 - 750 VOLTS	2 FT
	750 - 8,700 VOLTS	4 FT
	8,700 - 50,000 VOLTS	6 FT

CONDUCTORS				POLES			
NUMBER	SIZE	KIND	VOLTAGE	LOCATION	LENGTH	CLASS	TYPE
3	1/0	ALSR	4800	A	40	5	WOOD
1	4/2T		120	B	40	5	"
				C	40	5	"
				D	40	5	"

APPROVED F.M. HOFFMAN GENERAL ENGINEERING DEPT. DATE 7-10-78  
DESIGNED BY S. TOROK OVERHEAD LINES DEPT. WARREN SER. LE

SPAN	SPAN LENGTH	LOWEST CONDUCTOR OVER R.R. TRACKS	STRINGING SAG AT 60°F	HEIGHT OF LOWEST CONDUCTOR OVER	
				R.R. TRACKS	R.R. SIGNAL WIRE
B-C	114.5'	4/2T LIGHT CIRC.	9"	27'	—

DRAWING REVISED  
6-28-78 S. TOROK.  
ROOM B-207 WSC.

NOTE ONE 4/2T CONDUCTOR CONSISTS OF TWO #9 ALUMINUM SOLID HARD WPX (4/4 NEOPRENE) CONDUCTORS AND ONE NO. 2 ACSR #1 MESSENGER.

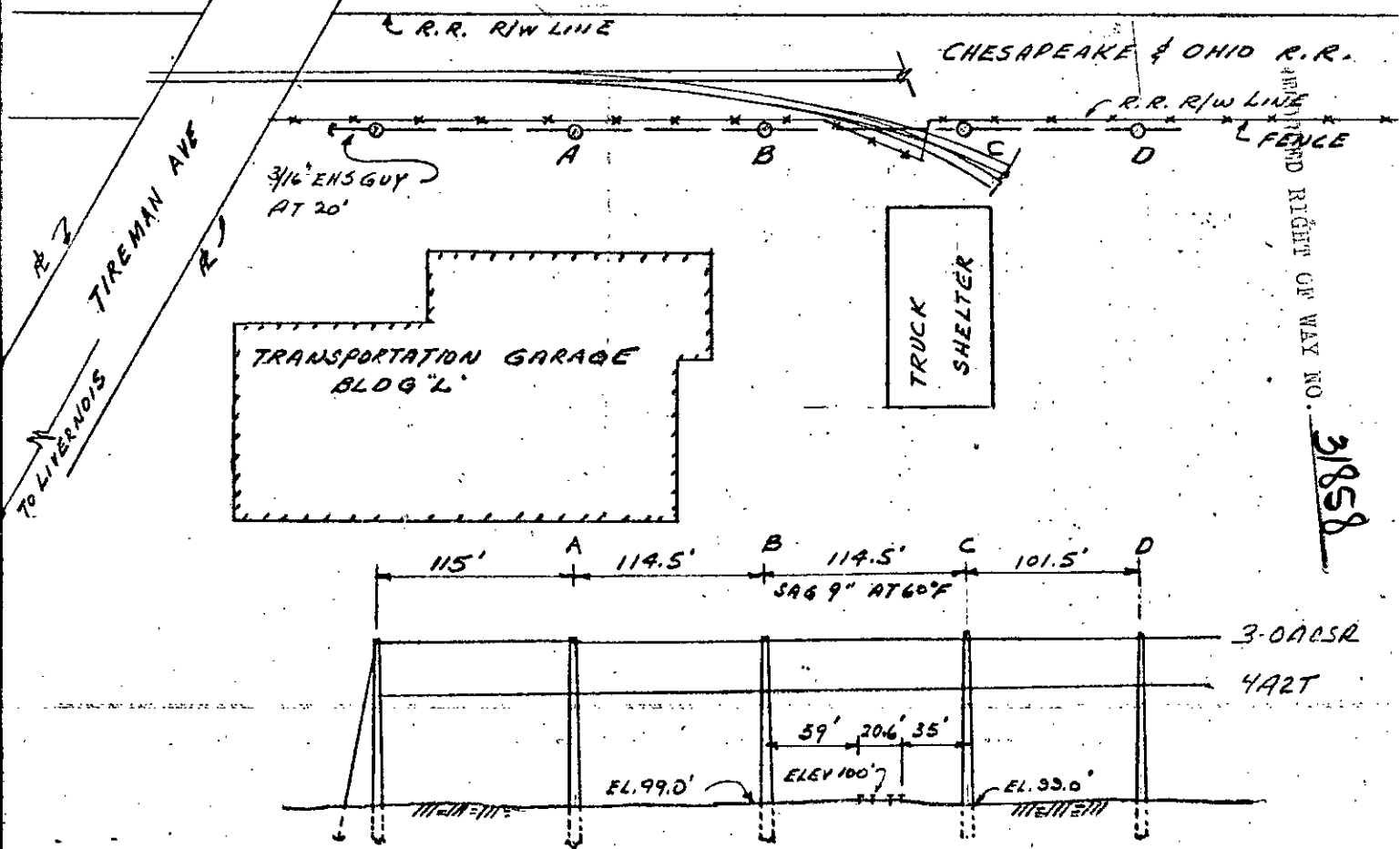

ELEVATION LOOKING NORTHEAST

RIGHT OF WAY NO. 31858

# THE DETROIT EDISON COMPANY

2000 SECOND AVENUE  
DETROIT, MICHIGAN 48226  
Overhead Lines Department

January 5, 1967

MICHIGAN PUBLIC SERVICE COMM.	
PUBLIC UTILITIES DIVISION	
Tel. _____	Gas _____
Elec. _____	R & S _____
JAN 10 1967	
Adm. _____	_____
File _____	_____

Permit No. ED 2-8-5800

Michigan Public Service Commission  
Lansing 13, Michigan

Gentlemen:

**D. Minter, Line Design Supervisor**

I, \_\_\_\_\_  
of The Detroit Edison Company, Detroit, Michigan, hereby certify that the  
wire crossing, covered by Wire Crossing Permit No. ED 2-8-5800,  
issued 5-13-66, has been constructed in accordance with  
specifications of the Michigan Public Service Commission and construction  
standards of The Detroit Edison Company, approved by Michigan Public Service  
Commission on July 19, 1939, file ED 2-9.01, and that this crossing will be  
maintained as provided in such specifications and construction standards.

Yours very truly,

*D. Minter*

RX No. 3787  
Location City of Detroit,  
Wayne County  
Railroad Chesapeake & Ohio  
File: 131-4-N-8340

Subscribed and sworn to before me this  
5th day of January, 19 .67  
Lyman G. Hedden  
Notary Public, Oakland  
County, Michigan.  
My Commission expires 9-19-70

31858

# THE DETROIT EDISON COMPANY

2000 SECOND AVENUE  
 DETROIT 26, MICHIGAN

May 10, 1966

Michigan Public Service Commission  
 Lansing 13, Michigan

Gentlemen:

The Detroit Edison Company, Detroit, Michigan, hereby makes application for authority to string the following wires over the tracks of the **Chesapeake and Ohio Railroad in the City of Detroit, Wayne County, Michigan.**

Span B-C

One 4A2T conductor 120/208 volt consisting of two #4 aluminum solid hard WPK (4/64 neoprene) conductors and one #2 ACSR 6/1 messenger wire over the tracks of the Chesapeake and Ohio Railroad located on private property at a point approximately 380' southwest of Tireson Avenue and 850' northeast of Livernois Avenue.

MICHIGAN PUBLIC SERVICE COMMISSION  
 PUBLIC UTILITIES DIVISION  
 Tel. \_\_\_\_\_ Gas \_\_\_\_\_  
 Elec. \_\_\_\_\_ R & S \_\_\_\_\_  
 MAY 13 1966  
 Adm. \_\_\_\_\_  
 File \_\_\_\_\_

The proposed wire crossing will be constructed in accordance with specifications of the Michigan Public Service Commission and the construction standards of The Detroit Edison Company, approved by the Michigan Public Service Commission on July 19, 1939, File ED 2-9.01.

- Enclosed is a waiver of hearing granted by the Railroad Company.
- Waiver of hearing by the Railroad Company is covered by blanket waiver.
- This application covers reconstruction of existing crossing and will cancel and supersede wire crossing permit No. \_\_\_\_\_ dated \_\_\_\_\_
- This is a new crossing.

Reference number of construction drawing is RX- 3787.

Waiver dated 5-5-66 attached  
 Railroad File: 131-4-N-8340  
 Permit No. ED2-8-5800  
 Date 5-13-66  
 By J. M. Hoppe

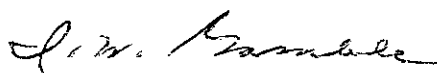
Yours very truly,  
  
 I. W. Gamble  
 Supervisor of Rights of Way  
 Properties and Rights of Way Dept.

RECORDED RIGHT OF WAY NO. 31858

Check in circle indicates statement applicable.





THE CHESAPEAKE AND OHIO RAILWAY COMPANY

May 5, 1966 JF/21  
File: 131-4-N-8340

The Detroit Edison Company  
2000 Second Avenue  
Detroit, Michigan 48226

Attention Mr. I. W. Gamble

I. W. GAMBLE

MAY 10 1966

PROR. & S/W DEPT.

Gentlemen:

Reference is made to your letter dated April 22, 1966, Plan RX-3787, requesting a waiver of hearing before the Michigan Public Service Commission to permit construction of an aerial power line crossing over our spur tracks on industry property opposite Station 118 plus 53 of the West Detroit Branch Subdivision, City of Detroit, Wayne County, Michigan.

The crossing will consist of one (1) 4A2T conductor 120/208 volt consisting of two (2) #4 aluminum solid hard WPX (4/64 neoprene) conductors and one (1) #2 ACSR 6/1 messenger wire (Span B-C), 27 feet above top of rails.

The Chesapeake and Ohio Railway Company hereby waives hearing before the Michigan Public Service Commission for permission to construct the above wire line crossing, with the provision that construction shall conform to the specifications of the Michigan Public Service Commission for such wire line crossings.

Very truly yours,

T. L. Carlson  
General Superintendent  
Signals and Communications

RECORDED FILED IN MAY 10 1966

31858

# THE DETROIT EDISON COMPANY

2000 SECOND AVENUE  
DETROIT, MICHIGAN 48226

TO:

April 22, 1966

Mr. T. L. Carlson, General Superintendent  
The Chesapeake and Ohio Railway Company  
Signals and Communications Department  
C & O Building, 405 Eleventh Avenue  
Huntington, West Virginia 25701

Proposed Overhead Wire Crossing: **One 4A2T conductor 120/208 volt consisting of two #4 aluminum solid hard WPX (1/64 neoprene) conductors and one #2 ACSR 6/1 messenger wire. Span B-C**

Specific Location **On private property at a point approximately 380 feet Southeast of Tireman Avenue and 850 feet Northeast of Livernois Avenue.**

R. R. Valuation Station \_\_\_\_\_ R. R. Mile Post \_\_\_\_\_

City/Village ~~Detroit~~ **Detroit** Township \_\_\_\_\_

County **Wayne** Detroit Edison Plan Attached **RX-3787**

This is a New Crossing  This is a Reconstruction of Existing Crossing \_\_\_\_\_

Previous Agreement Information (if any) Date \_\_\_\_\_ (R. R. Plan) \_\_\_\_\_

Blanket Waiver of Hearing Covers \_\_\_\_\_ Waiver of Hearing Requested **In Duplicate**  
(Waiver of Hearing to be mailed to applicant listed below)

All construction will be done in accordance with the rules and regulations of the Michigan Public Service Commission.

*I. W. Gamble*  
I. W. Gamble, Supervisor of Rights of Way  
Properties and Rights of Way Department

WWS/jft

APPROVED BY \_\_\_\_\_  
DATE \_\_\_\_\_  
31858

PROPOSED LINE CROSSING OVER CHESAPEAKE AND OHIO R.R. EXISTING PERMIT NUMBER NEW CROSSING  
IN PRI. PROPERTY APPROX. 380' SE OF TIREMAN AVE  
AND 850' NE OF LIVERNOIS AVE. CITY OF DETROIT

SECTION \_\_\_\_\_ TOWNSHIP (DET. 180) T \_\_\_\_\_ R \_\_\_\_\_ COUNTY WAYNE

**NOTES**

MATERIALS SHALL BE AS NOTED IN THE DETROIT EDISON COMPANY'S GENERAL SPECIFICATIONS FOR OVERHEAD LINE CONSTRUCTION AT RAILROAD CROSSINGS DATED MARCH 1955.

ACTUAL FIELD DIMENSIONS MAY VARY SOMEWHAT FROM THOSE SHOWN BUT THE REQUIREMENTS OF ORDER NO. 1679 OF MICHIGAN PUBLIC SERVICE COMMISSION AS REVISED JAN. 1, 1944. WILL BE COMPLIED WITH

**MINIMUM CLEARANCES**

NEAREST POLE TO RAIL	SIDING	7 FT
	MAIN LINE	12 FT
WIRES OVER TRACKS	0 - 750 VOLTS	27 FT
	750 - 15,000 VOLTS	28 FT
	15,000 - 50,000 VOLTS	30 FT
WIRES OVER R R SIGNAL	0 - 750 VOLTS	2 FT
	750 - 8,700 VOLTS	4 FT
	8,700 - 50,000 VOLTS	6 FT

CONDUCTORS				POLES			
NUMBER	SIZE	KIND	VOLTAGE	LOCATION	LENGTH	CLASS	TYPE
PROPOSED SPAN B-C				A	35	6	WOOD
1	4A2T		120/208	B	35	4	"
			ST. LIGHT	C	35	4	"
				D	35	6	"

APPROVED H. GEPPERT GENERAL ENGINEERING DEPT. DATE 4-18-66  
DESIGNED BY J. CARPENTER OVERHEAD LINES DEPT. WARREN SER. CEN.

SPAN	SPAN LENGTH	LOWEST CONDUCTOR OVER R.R. TRACKS	STRINGING SAG AT 60°F	HEIGHT OF LOWEST CONDUCTOR OVER	
				R.R. TRACKS	R.R. SIGNAL WIRE
B-C	114.5'	4A2T LIGHT CONC.	9"	27'	

NOTE ONE 4A2T CONDUCTOR CONSISTS OF TWO #4 ALUMINUM SOLID HARD WAX (4/64 NEOPRENE) CONDUCTORS AND ONE NO. 2 ACSR #1 MESSENGER.

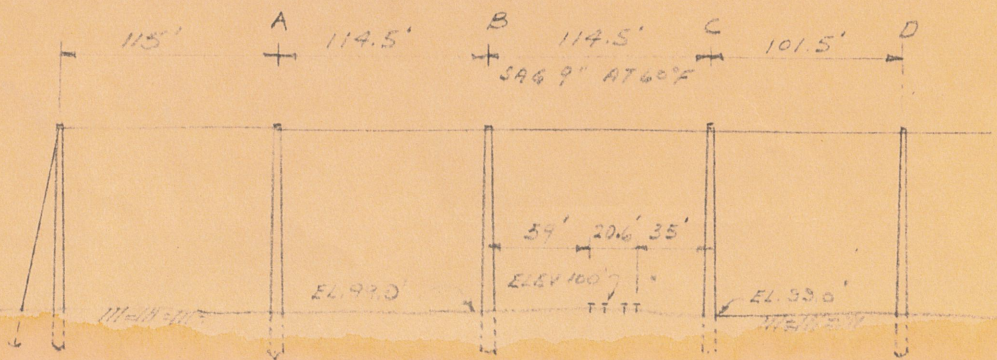
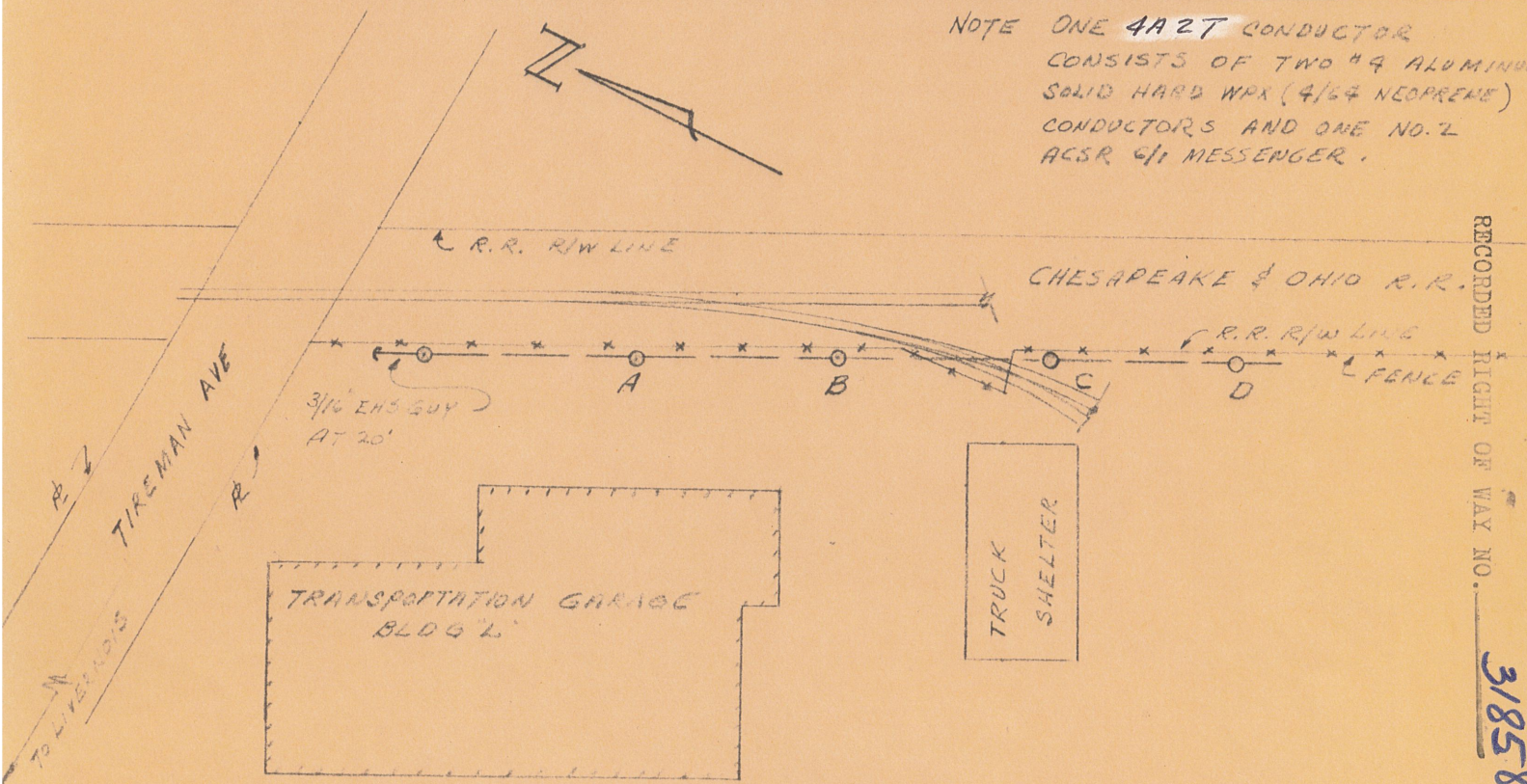

RECORDED RIGHT OF WAY NO. 31858

W.W.S.