

RE-RECORD

G310408

G454634

LI20679PA379
LI20157PA184

APARTMENTS

AGREEMENT - EASEMENT - RESTRICTIONS

This instrument made this 19th day of May, 1978, by and between the undersigned Owners and THE DETROIT EDISON COMPANY, a corporation organized and existing concurrently under the laws of the states of Michigan and New York, of 2000 Second Avenue, Detroit, Michigan, 48226, hereinafter called "EDISON", and MICHIGAN BELL TELEPHONE COMPANY, a Michigan corporation, of 1365 Cass Avenue, Detroit, Michigan, 48226, hereinafter called "BELL."

W I T N E S S E T H :

WHEREAS, Owners are erecting apartments known as LIGHT HOUSE POINT APARTMENTS, on land in the Township of Van Buren, County of Wayne, State of Michigan, as described in Appendix "A", attached hereto and made a part hereof, and EDISON and BELL will install their electric and communication facilities underground except necessary above ground equipment.

NOW, THEREFORE, in consideration of the mutual promises and covenants for the installation of underground utility service made by the parties hereto, it is hereby agreed:

(1) The installation, ownership and maintenance of electric services and the charges to be made therefor shall be subject to and in accordance with the Orders and Rules and Regulations adopted from time to time by the Michigan Public Service Commission.

(2) Owners must certify to EDISON and BELL that the easements are graded to within four (4") inches of final grade before the underground facilities are installed.

(3) Owners further agree that if subsequent to the installation of the utility facilities of EDISON and BELL, it is necessary to repair, move, modify, rearrange or relocate any of their facilities to conform to a new plot plan or change of grade or for any cause or changes attributable to public authority having jurisdiction or to Owners action or request, Owners will pay the cost and expense of repairing, moving, rearrangement or relocating said facilities to EDISON or BELL upon receipt of a statement therefor. Further, if the lines or facilities of EDISON and BELL are damaged by acts of negligence on the part of the Owners or by contractors engaged by Owners, repairs shall be made by the utilities named herein at the cost and expense of the Owners and shall be paid to EDISON or BELL upon receiving a statement therefor. Owners are defined as those persons owning the land at the time damage occurred.

(4) Owners hereby grant to EDISON and BELL easement for electric and communication underground services in land herein described. When utility lines are installed, this instrument shall be re-recorded with an "as installed" drawing showing the location of utility facilities in relation to building lines and indicating the easements by their centerlines. Easements herein granted shall be six (6') feet in width unless otherwise indicated on said drawing. However, secondary electric service and communication entrance line locations, as shown on an installed drawing are not guaranteed; actual locations can be determined after contact with utilities.

(5) Owners to pay the cost of conduit for electric and/or communication facilities to accomodate patios or similar site conditions.

(6) Easements herein granted are subject to the following restrictions and additional conditions:

a. Said easements shall be subject to Order of and the Rules and Regulations adopted from time to time by the Michigan Public Service Commission.

"THIS EASEMENT IS RE-RECORDED FOR PURPOSES OF SHOWING THE PLANNED "AS INSTALLED" CENTERLINES OF EASEMENTS GRANTED AS SHOWN ON DRAWING ATTACHED HERETO"
DE FORM LE 11 11 71 CS

-1-

RECORDED JUN 22 1978 AT 10340
FOREST E. YOUNGBLOOD, Register of Deeds
WAYNE COUNTY, MICHIGAN 48226

RECORDED OCT 17 1979 AT 1130
FOREST E. YOUNGBLOOD, Register of Deeds
WAYNE COUNTY, MICHIGAN 48226

G454634

G310408

51678

LI20679PA384

LI20679PA385



LOCATION SKETCH
U. G. MAP SEC. NOS. VAB 52-3

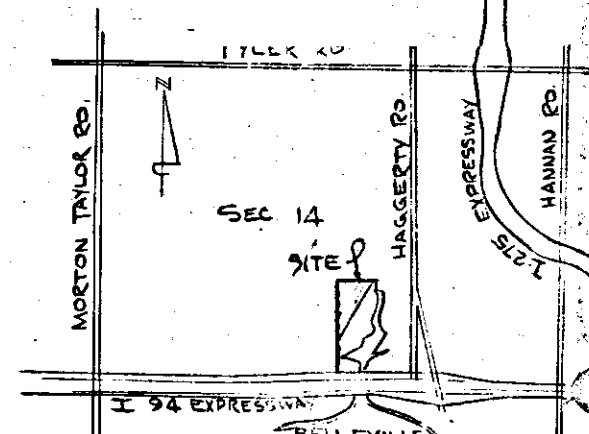

TRANSFORMER SPECS. 1126, R 351E
PEDESTAL SPEC.-R13
NO. OF PEDESTALS 0

- CODE -**
- ⊕ TEMPORARY SECONDARY PEDESTAL
 - ⊖ DFT (DEAD FRONT TYPE)
 - UDT (NON-SWITCHING-LIVE FRONT TYPE)
 - ⊗ UDT (SWITCHING-LIVE FRONT TYPE)
 - DIRECTION OF TRANSFORMER DOOR OPENING
 - SECONDARY PEDESTAL
 - ▲ SECONDARY TERMINAL
 - ⊙ CABLE POLE
 - ⊠ PRIMARY SWITCH CABINET
 - BURIED PRIMARY CABLE-ALL VOLTAGES
 - BURIED SECONDARY CABLE
 - BURIED SECONDARY SERVICE CABLE
 - DETROIT EDISON TRENCH ONLY
 - TELEPHONE TRENCH ONLY
 - SEWER
 - WATER
 - GAS
 - PROPOSED CONDUIT

CABLE SUMMARY

ITEM# 455	#2A ALX 1 13.2 KV	713-3062 = 3,650'
ITEM# 437	AP2-350M & 1-4/0 600 V.	713-0537 = 300'
ITEM#	AP2-2/0 & 1-#1 600 V.	713-0614 =

TRENCH SUMMARY

JOINT USE	2,150'	SERV. TRENCH	120'
D. E. ONLY	640'		
TEL ONLY	340'		
TOTAL	3,130'		

SITE SUPT. _____
PHONE NO. _____
East 1/4 Cor. Sec. 14

TRANSFORMER DATA

U.D.T. NO.	SIZE	ED. STK. NO.
M936-1	100	661-1153
2	100	1153
3	100	1153
M937-1	100	1153
2	100	1153
3006-3	100	1153
3006-4	100	1153

GENERAL NOTES

TRENCHING TO BE DONE BY DECO.
TRENCH AND CABLE LENGTHS ARE APPROXIMATE.
SEE DRAWING UI-4-2369 FOR TRANS. MAT. DETAILS.
SEE PAGE 32-11 (S.I.M.) DETAIL " " FOR ENTRANCE POINT DETAILS (APTS. ONLY).
SEE DRAWING UI-4-2263 FOR PLACEMENT OF CABLES, TRANSFORMERS AND PEDESTALS (SUB'DS ONLY).
D.E. SERVICE PLANNER: DAVE FULMER 295 1650
TEL. CO.: DICK DROZDOWSKI 285 9239

CONTACT "MISS DIG" 452 7171 BEFORE DOING ANY EXCAVATION.
EASEMENTS INDICATED BY OUR CENTERLINES ARE (6') SIX FEET IN WIDTH UNLESS OTHERWISE NOTED.

PERMITS REQUIRED

RECORDED RIGHT OF WAY
31678

VAN BUREN EST SUB.
DRWG. WU2-4-2375

RECORDED RIGHT OF WAY
31678

DEPT. ORDER: 78A-34020
WORK ORDER: 367B13J195
START: 11-27-78
FINISH: 1-30-79
LABOR: HEATH ENERGY INC.

D	REVISION	C	REVISION	B	REVISION	A	REVISION	REFERENCE	DRAWN BY	CHECKED BY	APPROVED BY	DATE	JOB TITLE	THE DETROIT EDISON COMPANY SERVICE PLANNING DEPARTMENT		
			AS INSTALLED IN FIELD FOR RECORDING		Note: CAUTION MBT IN AREA Tf in PRIMARY OFF Bldg's NOTE: BORE TREE	RELOCATE: 1) BLDG # 1 (20's) 2) U.D.T. M936-1		WU2-4-2375	S.F. ZAGATA	DAVE FULMER	JOHN CHAD	3-20-78 3-21-78 3-31-78	LIGHTHOUSE POINT APTS. Part of the SE 1/4 of Sec. 14, T35, R9E VAN BUREN TWP.	SCALE: 1" = 50'	NUMBER OF UNITS: 167	WORK ORDER NUMBER: 367-B13J195
														LATEST REVISION: B	DISTRIBUTION CIRCUIT: 9357 HOMER	DEPT. ORDER NUMBER: 78A-34020
																SHEET 1 OF 1 SHEETS

RETURN TO:
Real Estate B/W & Claims
8750 Telegraph (Rm. 225)
Taylor, MI 48120

RETURN TO:
Real Estate, R/W & Claims
8750 Telegraph (Rm. 225)
Taylor, MI 48180

RECORDED RIGHT OF WAY NO. 31678

31678

RECORDED

RECORDED