

AGREEMENT - EASEMENT - RESTRICTIONS

This instrument made this 8<sup>TH</sup> day of NOVEMBER, 1976, by and between the undersigned Owners and THE DETROIT EDISON COMPANY, a corporation organized and existing concurrently under the laws of the states of Michigan and New York, of 2000 Second Avenue, Detroit, Michigan, 48226, hereinafter called "EDISON", and MICHIGAN BELL TELEPHONE COMPANY, a Michigan Corporation, of 1365 Cass Avenue, Detroit, Michigan, 48226, hereinafter called "BELL".

W I T N E S S E T H :

WHEREAS, Owners are erecting apartments known as Potomac Towne II, a condominium project, on land in the Township of West Bloomfield, County of Oakland, State of Michigan, as described in Appendix "A", attached hereto and made a part hereof, and EDISON and BELL will install their electric and communication facilities underground except necessary above ground equipment.

NOW, THEREFORE, in consideration of the mutual promises and covenants for the installation of underground utility service made by the parties hereto, it is hereby agreed:

(1) The installation, ownership and maintenance of electric services and the charges to be made therefor shall be subject to and in accordance with the Orders and Rules and Regulations adopted from time to time by the Michigan Public Service Commission.

(2) Owners must certify to EDISON and BELL that the easements are graded to within four (4") inches of final grade before the underground facilities are installed.

(3) Owners further agree that if subsequent to the installation of the utility facilities of EDISON and BELL, it is necessary to repair, move, modify, rearrange or relocate any of their facilities to conform to a new plot plan or change of grade or for any cause or changes attributable to public authority having jurisdiction or to Owners action or request, Owners will pay the cost and expense of repairing, moving, rearrangement or relocating said facilities to EDISON and BELL upon receipt of a statement therefor. Further, if the lines or facilities of EDISON and BELL are damaged by acts of negligence on the part of the Owners or by contractors engaged by Owners, repairs shall be made by the utilities named herein at the cost and expense of the Owners and shall be paid to EDISON or BELL upon receiving a statement therefor. Owners are defined as those persons owning the land at the time damage occurred.

(4) Owners hereby grant to EDISON and BELL easement for electric and communication underground services in land herein described. When utility lines are installed, this instrument shall be re-recorded with an "as installed" drawing showing the location of utility facilities in relation to building lines and indicating the easements by their centerlines. Easements herein granted shall be six (6') feet in width unless otherwise indicated on said drawing. However, secondary electric service and communication entrance line locations, as shown on an "as installed" drawing are not guaranteed; actual locations can be determined after contact with utilities.

(5) Owners to pay the cost of conduit for electric and/or communication facilities to accommodate patios or similar site conditions.

(6) Easements herein granted are subject to the following restrictions and additional conditions:

a. Said easements shall be subject to Orders of and the Rules and Regulations adopted from time to time by the Michigan Public Service Commission.

b. Owners will place survey stakes indicating building plot lines and property lines before trenching.

RECORDED DIRECT OF TAX NO. 30947

PAD DETAIL OF P.S.C. 336

PAD DETAIL OF P.S.C. 335



LIBER 8053 PAGE 795

LIBER 8053 PAGE 796

LIBER 8053 PAGE 797

LOCATION SKETCH  
U.S. MAP SEC. NO. WBL 85-4 / 26-3

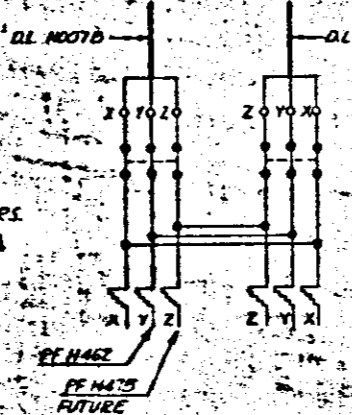
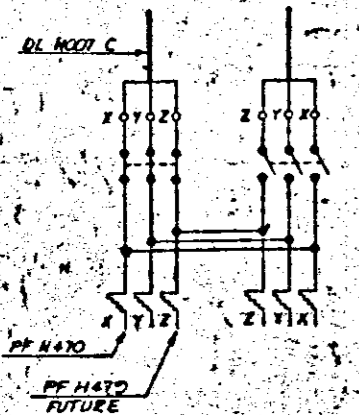
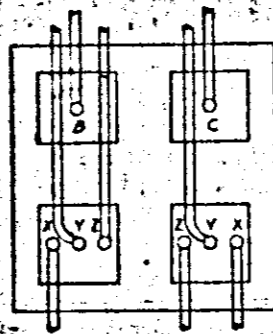
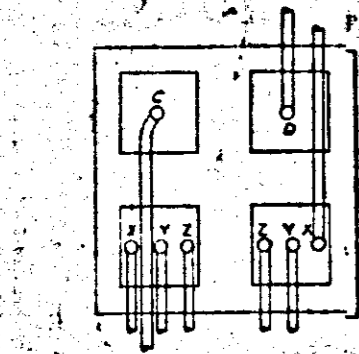

FUSE SIZE FOR PRIM. FDRS.  
TO BE GSE WITH SM153  
SIZE & CARRIERS.

SCHEMATIC OF P.S.C. 336

SCHEMATIC OF P.S.C. 335

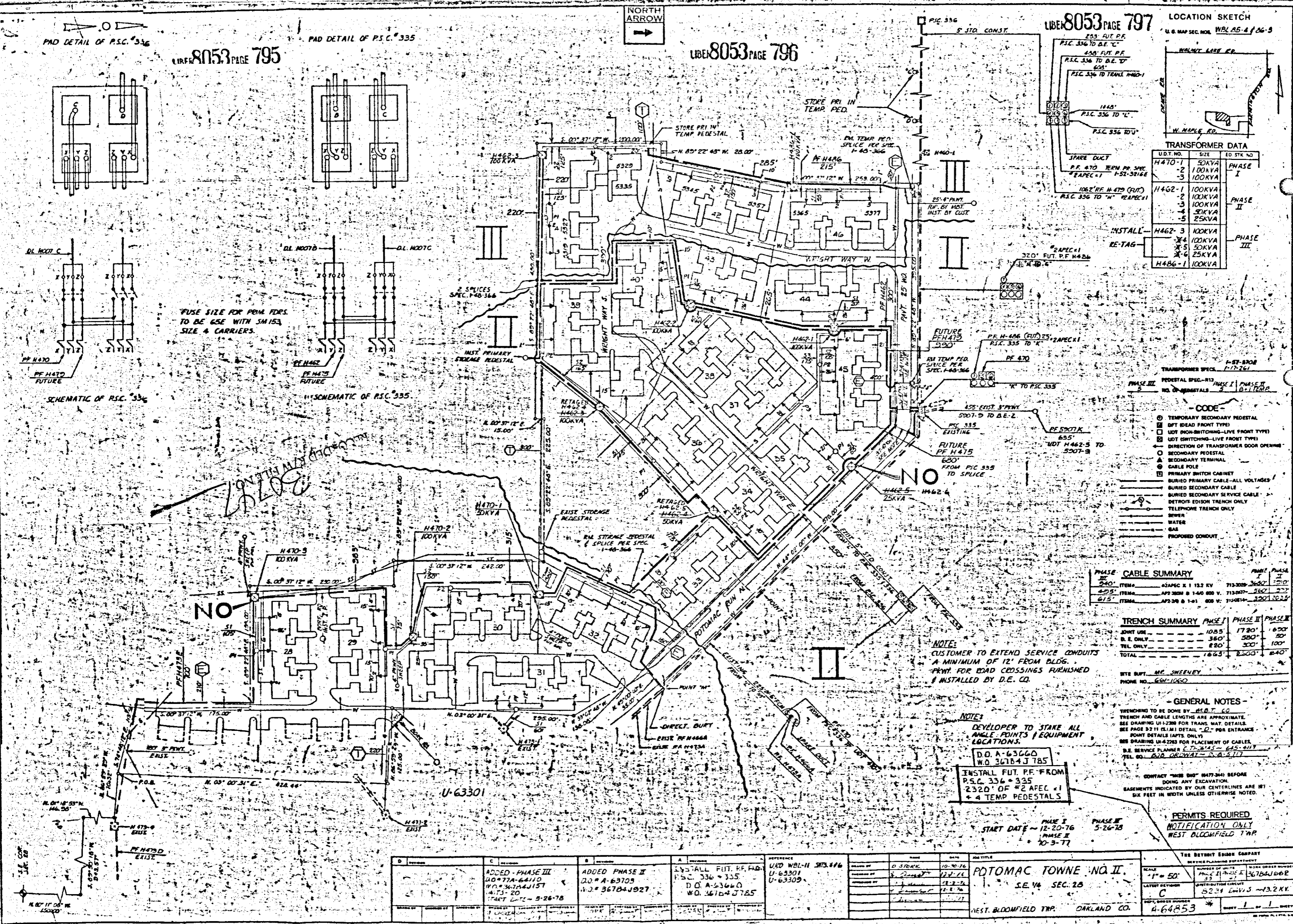

**TRANSFORMER DATA**

UDT. NO.	SIZE	ED STK NO.	PHASE
H470-1	50KVA		PHASE I
-2	100KVA		
-3	100KVA		
H462-1	100KVA		PHASE II
-2	100KVA		
-3	100KVA		
-4	50KVA		
-5	25KVA		
INSTALL - H462-3	100KVA		PHASE III
-4	100KVA		
-5	50KVA		
RE-TAG - H486-1	100KVA		

**TRANSFORMER SPEC.**

PHASE III	PHASE II	PHASE I	PHASE II
PEDESTAL SPEC.-R12			
NO. OF TRANSFORMERS	2	1	1

- CODE**
- ⊙ TEMPORARY SECONDARY PEDESTAL
  - ⊙ DFT IDEAL FRONT TYPE
  - ⊙ UDT (NON-SWITCHING-LIVE FRONT TYPE)
  - ⊙ UDT (SWITCHING-LIVE FRONT TYPE)
  - ⊙ DIRECTION OF TRANSFORMER DOOR OPENING
  - SECONDARY PEDESTAL
  - SECONDARY TERMINAL
  - CABLE POLE
  - ⊙ PRIMARY SWITCH CABINET
  - ⊙ BURIED PRIMARY CABLE-ALL VOLTAGES
  - ⊙ BURIED SECONDARY CABLE
  - ⊙ BURIED SECONDARY SERVICE CABLE
  - ⊙ DETROIT EDISON TRENCH ONLY
  - ⊙ TELEPHONE TRENCH ONLY
  - ⊙ SEWER
  - ⊙ WATER
  - ⊙ GAS
  - ⊙ PROPOSED CONDUIT

**PHASE CABLE SUMMARY**

ITEM	QTY	DESCRIPTION	PHASE I	PHASE II	PHASE III
340'		42APC X 1 132 KV	713-2029	2660	2310
420'		AP230N B 1-40 800 V.	713-0077	560	277
615'		AP230 B 1-41 800 V.	712-0814	1201	1025

**TRENCH SUMMARY**

JOINT USE	PHASE I	PHASE II	PHASE III
B. E. ONLY	1085	1720	1620
TEL ONLY	360	300	100
TOTAL	1445	2020	1720

SITE SUPT. MR. SWEENEY  
PHONE NO. 661-1060

**GENERAL NOTES**

TRENCHING TO BE DONE BY D.E. CO.  
TRENCH AND CABLE LENGTHS ARE APPROXIMATE.  
SEE DRAWING U1-2286 FOR TRANS. MAT. DETAILS.  
SEE PAGE 32 (I) (L) DETAIL "L" FOR ENTRANCE POINT DETAILS (APTS. ONLY).  
SEE DRAWING U1-2283 FOR PLACEMENT OF CABLES.  
D.E. SERVICE PLANNER C. J. WILSON  
TEL. NO. 628-0800

**NOTE:**  
CUSTOMER TO EXTEND SERVICE CONDUITS A MINIMUM OF 12' FROM BLDG. PRVNT. FOR ROAD CROSSINGS FURNISHED & INSTALLED BY D.E. CO.

**NOTE:**  
DEVELOPER TO STAKE ALL ANGLE POINTS / EQUIPMENT LOCATIONS.

D.O.A. 63660  
W.O. 36784J 785  
INSTALL FUT. PF FROM P.S.C. 336-335 2320' OF #2 APC X 1 + 4 TEMP PEDESTALS

PHASE I START DATE ~ 12-20-76  
PHASE II 5-26-78  
PHASE III 10-3-77

**PERMITS REQUIRED**  
NOTIFICATION ONLY  
WEST BLOOMFIELD TWP.

D	C	B	A	REFERENCE	DATE	DESCRIPTION
	ADDED - PHASE III D.O.A. 63710 W.O. 36784J 157 H.T.S. 20 START DATE ~ 5-26-78	ADDED PHASE II D.O.A. 63709 W.O. 36784J 927	INSTALL FUT. PF FROM P.S.C. 336-335 D.O.A. 63660 W.O. 36784J 785	U&D WBL-11 573.816 U-63301 U-63309	10-30-76 11-17-76 11-27-76 11-27-76	BY: [Signature]

THE DETROIT EDISON COMPANY  
SERVICE PLANNING DEPARTMENT  
SCALE: 1" = 50'  
NUMBER OF SHEETS: 3  
WORK ORDER NUMBER: 36784J 002  
LATEST REVISION: C  
DISTRIBUTION CIRCUIT: 5231 EDWIS - 13.2KV  
SHEET 1 OF 1 SHEETS

RECORDED RIGHT OF WAY NO. 30747

30747