

TIFFANY SQUARE CONDOMINIUMS
APARTMENTS

LIBER 6880 PAGE 679 AGREEMENT - EASEMENT - RESTRICTIONS

This instrument made this 29th day of AUGUST, 19 73, by and between the undersigned Owners and THE DETROIT EDISON COMPANY, a corporation organized and existing concurrently under the laws of the states of Michigan and New York, of 2000 Second Avenue, Detroit, Michigan, 48226, hereinafter called "EDISON", and MICHIGAN BELL TELEPHONE COMPANY, a Michigan corporation, of 1365 Cass Avenue, Detroit, Michigan, 48226, hereinafter called "BELL."

WITNESSETH:

WHEREAS, Owners are erecting ^{condominiums} ~~apartments~~ known as Tiffany Square, on land in the City of ~~New~~ Southfield, County of Oakland, State of Michigan, as described in Appendix "A", attached hereto and made a part hereof, and EDISON and BELL will install their electric and communication facilities underground except necessary ~~above~~ ^{above} ground equipment.

NOW, THEREFORE, in consideration of the mutual promises and covenants for the installation of underground utility service made by the parties hereto it is hereby agreed:

- (1) The installation, ownership and maintenance of electric services and the charges to be made therefor shall be subject to and in accordance with the Orders and Regulations adopted from time to time by the Michigan Public Service Commission.
- (2) Owners must certify to EDISON and BELL that the easements are graded to within four (4") inches of final grade before the underground facilities are installed.
- (3) Owners further agree that if subsequent to the installation of the utility facilities of EDISON and BELL, it is necessary to repair, move, modify, rearrange or relocate any of their facilities to conform to a new plot plan or change of grade or for any cause or changes attributable to public authority having jurisdiction or to Owners action or request, Owners will pay the cost and expense of repairing, moving, rearrangement or relocating said facilities to EDISON or BELL upon receipt of a statement therefor. Further, if the lines or facilities of EDISON and BELL are damaged by acts of negligence on the part of the Owners or by contractors engaged by Owners, repairs shall be made by the utilities named herein at the cost and expense of the Owners and shall be paid to EDISON or BELL upon receiving a statement therefor. Owners are defined as those persons owning the land at the time damage occurred.
- (4) Owners hereby grant to EDISON and BELL easement for electric and communication underground services in land herein described. When utility lines are installed, this instrument shall be re-recorded with an "as installed" drawing showing the location of utility facilities in relation to building lines and indicating the easements by their centerlines. Easements herein granted shall be six (6') feet in width unless otherwise indicated on said drawing. However, secondary electric service and communication entrance line locations, as shown on an installed drawing are not guaranteed; actual locations can be determined after contact with utilities.
- (5) Owners to pay the cost of conduit for electric and/or communication facilities to accomodate patios or similar site conditions.
- (6) Easements herein granted are subject to the following restrictions and additional conditions:

a. Said easements shall be subject to Order of and the Rules and Regulations adopted from time to time by the Michigan Public Service Commission.

"This easement is re-recorded for purposes of showing the planned "as installed" centerlines of easements granted as shown on drawing attached hereto." -1-

~~Ret. Detroit Edison Co.
1970 Orchard Lake Rd
Pantoloi 48053 att. J.A. Robertson~~

RECORDED
MICHIGAN
PUBLIC SERVICE
COMMISSION
157 APR 1973
PH

RECORDED NIGHT OF MAY NO. 30337

15.00
1500

01358
01358

01358

01358

01358

01358

RETURN TO
J. A. ROBERTSON
THE DETROIT EDISON COMPANY
30400 TELEGRAPH ROAD, 272 OAKDH
BIRMINGHAM, MICHIGAN 48010

By the undersigned...

- b. Owners will place survey stakes indicating building plot lines and property lines before trenching.
- c. No shrubs or foliage shall be permitted on Owners land within five (5') feet of front door of transformers or switching cabinet enclosures.
- d. Sanitary sewers shall be installed prior to installation of electric and communication lines. Sewer, water and gas lines may cross easements granted for electric and communication lines, but shall not be installed parallel within said easements.
- e. Owners shall make no excavations nor erect any structures within the easements identified on the "as installed" drawing. No excavations for fences shall be allowed within the limits of the utility easements provided for electric and communication lines unless prior written approval is secured from the utilities.
- f. Owners to provide for clearing the easements of trees, large stumps, and obstructions sufficiently to allow trenching equipment to operate. Owners to pay to utility concerned the extra trenching costs involved if trenching is required while ground is frozen.
- g. EDISON and BELL shall have the right of access at all times upon premises for the purposes of constructing, repairing, and maintaining their electric and communication lines and facilities.
- h. Any of the undersigned who are vendors on land contracts wherein a portion of the lands described herein are being sold shall not be liable to BELL or EDISON unless and until the interest of the vendees, under any such contracts, have been forfeited and damage to utility lines and equipment occurs after such forfeiture.

The provisions of this instrument shall run with the land and shall be binding upon and inure to the benefit of the respective heirs, administrators, executors, personal representatives, successors and assigns of the parties hereto.

IN WITNESS WHEREOF, the parties hereto have set their hands and seals on the day and year first above written.

In the Presence of:

Diane Drummey
DIANE DRUMMEY

Irene C. Kata
IRENE C. KATA

Linda Perry
LINDA PERRY

Marsha Pavelka
MARSHA PAVELKA

THE DETROIT EDISON COMPANY

By *W. C. Arnold*
W. C. Arnold, Director, Real Estate and Rights of Way Dept.

By *Lillian J. H. Carroll* 8-31-73
LILLIAN J. H. CARROLL ASST. SECRETARY

MICHIGAN BELL TELEPHONE COMPANY

By *William F. Murray, Jr.*
WILLIAM F. MURRAY, JR.
Staff Supervisor, Right of Way
(authorized signature)

RECORDED RIGHT OF WAY NO. 30337

NOTED
MICHIGAN BELL TELEPHONE COMPANY
HONORARY ALBION STANDISH
JULIA MICHIGAN BELL TELEPHONE COMPANY

080-0700

817 8010

012 0800

RETURN TO
J. A. ROBERTSON
THE DETROIT EDISON COMPANY
30400 TELEGRAPH ROAD, 272 OAKDH
BIRMINGHAM, MICHIGAN 48010

DAVE GRIMMEY

STATE OF MICHIGAN)
) SS
 COUNTY OF WAYNE)

On this 4th day of September, 19 73, before me, the subscriber, a Notary Public in and for said County, personally appeared W. C. Arnold and Lillian J.H. Carroll to me personally known, who being by me duly sworn, did say that they are the Director, RE & R/W Dept. and an Assistant Secretary of THE DETROIT EDISON COMPANY, a corporation organized and existing concurrently under the laws of Michigan and New York, and that the seal affixed to said instrument is the corporate seal of the said corporation, and that said instrument was signed in behalf of said corporation by authority of its Board of Directors and W. C. Arnold and Lillian J.H. Carroll acknowledged said instrument to be the free act and deed of said Corporation.

My commission expires: May 14, 1976

Irene G. Kata
 Notary Public **IRENE G. KATA**
Wayne County, Michigan

RECORDED
 OAKLAND COUNTY MICHIGAN
 REGISTER OF DEEDS
 1973 SEP 14 AM 11:06
 IYAN D. ALLEN
 CLERK-REGISTER OF DEEDS

STATE OF MICHIGAN)
) SS
 COUNTY OF OAKLAND)

On this 10th day of September, 19 73, before me, the subscriber, a Notary Public in and for said County, appeared William F. Murray Jr. to me personally known, who being by me duly sworn, did say that he is Staff Supervisor of Right of Way, authorized by and for MICHIGAN BELL TELEPHONE COMPANY, a Michigan Corporation, and that the said instrument was signed in behalf of said Corporation, by authority of its Board of Directors, and William F. Murray Jr. acknowledged said instrument to be the free act and deed of said corporation.

My commission expires: _____

Melford Hartman
 Notary Public

MELFORD HARTMAN
 Notary Public, Wayne County, Michigan
 Acting In Oakland County
 My Commission Expires Sept. 15, 1975

_____ County, Michigan

RECORDED NIGHT OF WAY NO. 30337

DETROIT EDISON COMPANY
 3000 TOWNSEND ROAD, DETROIT, MICHIGAN 48202
 3

1980-1981

115-1800

1980-1981

RETURN TO
J. A. ROBERTSON
THE DETROIT EDISON COMPANY
30400 TELEGRAPH ROAD, 272 OAKDH
BIRMINGHAM, MICHIGAN 48010

TIF, Inc., a Michigan Corporation
18911 W. Ten Mile Rd.
Southfield, Michigan 48075

Witness:

Bert Keehr

Bert Keehr

Al. A. Shacket

Al. A. Shacket, President

Evelyn Solomone

Evelyn Solomone

Leroy Helfman

Leroy Helfman, Sec. Treas.

STATE OF MICHIGAN)
) SS:
COUNTY OF OAKLAND)

Personally came before me this 29 day of August, 1973

Al. A. Shacket and Leroy Helfman
of the above named corporation, to me known to be the persons who executed the foregoing instrument and to me known to be such President and Sec. Treas. of said corporation, and acknowledged that they executed the foregoing instrument as such officers as the free act and deed of said corporation, by its authority.

My Commission Expires: 10/5/76

Sylvia Rose
SYLVIA ROSE
Notary Public,

Oakland
County, Michigan

APPENDIX "A"

Lots 35 and 36, Supervisor's Plat No. 22, a Plat of the Southwest 1/4 of the Southwest 1/4 of Section 8, Township 1 North, Range 10 East, Southfield Township, Oakland County, Michigan according to the plat thereof as recorded in Liber 6, Page 42 of Plats, Oakland County Records.

Prepared by: John N. Waterloo
1970 Orchard Lake Road
Pontiac, Michigan 48053

RECORDED RIGHT OF WAY NO. 30337
RECORDED, MICHIGAN
OAKLAND COUNTY RECORDS
REGISTER OF DEEDS
1976 FEB 23 PM 4: 17
Lynn D. Allen
LYNN D. ALLEN
CLERK-REGISTER OF DEEDS

RETURN TO
J. A. ROBERTSON
THE DETROIT EDISON COMPANY
30400 TELEGRAPH ROAD, 2721 OAKHURST
BIRMINGHAM, MICHIGAN 48010

Original recorded in Liber 6, Page 42 of Plats, Oakland County Records.

LIBER 8888 PAGE 212

LIBER 8888 PAGE 212

1888

LIBER 8888
PAGE 212

Original Recorded.....
Liber.....
Page.....

RETURN TO
J. A. ROBERTSON
THE DETROIT EDISON COMPANY
30400 TELEGRAPH ROAD, 272 OAKDH
BIRMINGHAM, MICHIGAN 48010

Detroit
Edison

Oakland Division
30400 Telegraph Road
Birmingham, Michigan 48019
(313) 645-2000
Phone 645-4378

March 1, 1976

Bell Development Company
18911 W. Ten Mile Road
Southfield, Michigan 48075

Gentlemen:

Re: TIFFANY SQUARE CONDOMINIUMS

We are enclosing herewith a copy of the "as installed" Drawing No.
A-63569 for the underground electric and communication
services for the above named project.

Sincerely,



John N. Waterloo, Representative
Real Estate and Rights of Way

RECORDED RIGHT OF WAY NO. 30337

THE DETROIT EDISON COMPANY

2000 SECOND AVENUE
DETROIT, MICHIGAN 48226

Date October 11, 1973

~~Bell Development Company~~
18911 W. 10 Mile, Suite 200
Southfield, Michigan 48075

Regarding Tiffany Square Condominiums

Gentlemen:

Subject to our agreement with you for the installation of underground electric lines in the above project, The Detroit Edison Company will own, install and maintain its electric lines and equipment and provide trenching in easements six feet (6') in width, which will be subsequently platted or provided by a separate easement instrument. Location of the lines and equipment will be as shown on the combined utility plan as approved by you on October 5, 1973.

The cost to you for said electric line installation is \$~~2,000.00~~ based on 1,000 trench feet or lot front feet. Extra charges in addition to the above will be \$ as your contribution for such items as providing primary mains, distribution laterals and primary switching cabinets. These extra charges will only be assessed if involved. All charges are based on rules and rates as filed with the Michigan Public Service Commission and as shown in our current rate book. We will require full payment of the aforementioned charges prior to energizing the system.

Service cable requirements will be fulfilled as per our rules and rates as filed with the Michigan Public Service Commission.

Community antenna systems or other cable systems shall not be installed in the same trench with Company and telephone cables without a separate signed agreement.

If adverse soil or field conditions such as rock, frozen ground or other are encountered, and you require us to trench through, additional charges will be assessed and may be billed at a later date. Additional charges will also be assessed if it is necessary to bore under paved streets or other paved areas.

Page 1

DE FORM PL 101 4-72 CS

RECORDED RIGHT OF WAY NO. 30337

Page 2
The Detroit Edison Company
Date October 11, 1973

Tiffany Square Condominiums

The future maintenance of our electric lines in the proposed easements does not include repair of damage to our lines and equipment caused by you, your contractors, agents, employees, successors and assignees. If such damage should occur, we will require reimbursement for any such damage.

Notwithstanding anything herein to the contrary, the installation, ownership and maintenance of electric services and the rates, fees, and charges to be made shall be subject to and in accordance with the orders and rules and regulations adopted and approved from time to time by the Michigan Public Service Commission.

Please sign three of the enclosed copies and return them. You may retain the fourth copy for your file.

Very truly yours,

Kenneth E. Conley
Service Planner

ACCEPTED:

Name 

Title Secretary, Treas

Name _____

Title _____

Date 11/6/73

RECORDED RIGHT OF WAY NO.

30337

THE DETROIT EDISON COMPANY

2000 SECOND AVENUE
DETROIT, MICHIGAN 48226

Date: November 12, 1973

Bell Development Company
18911 W. Ten Mile, Suite 200
Southfield, Michigan 48075
Re: Tiffany Square Condominiums

Gentlemen:

Pursuant to establishing a field construction date for the above named project, it is necessary that the conditions of the grade in the area of construction be determined. Work cannot start until this is accomplished. In addition, if the field construction is done during the period of December 15 through March 31, winter construction charges will be assessed. These charges are \$ 1.00 per linear foot of trench.

Please sign and return ^{one copy} ~~three copies~~ of the certificate below. You may retain the ~~fourth~~ copy for your file.
second

Very truly yours,

Ken Conley
Ken Conley
Service Planner

November 12, 1973
Date

C-E-R-T-I-F-I-C-A-T-E

I/We, the undersigned, hereby certify to The Detroit Edison Company that all grading in utility easements and/or the routes of the underground facilities on the above subject development has been completed within four(4) inches of final grade.

I/We, the undersigned, agree to pay all winter construction charges if involved, at a price not to exceed that shown above and further agree that a stake will be placed at the location of each piece of above grade equipment, indicating the final grade to be achieved. A copy of The Detroit Edison Company underground construction drawing No. A-63569 for this development is in my/our possession and will be used for this purpose.

Best Tech

Signed

Signed
Mr. Scott

Title
11-30-73

Date

RECORDED RIGHT OF WAY NO. 30337

THE DETROIT EDISON COMPANY

1970 ORCHARD LAKE ROAD

PONTIAC, MICHIGAN 48053

September 25, 1973

Bell Development Co.
18911 W. Ten Mile Rd.
Southfield, Michigan 48075

RE: TIFFANY SQUARE CONDOMINIUMS

Gentlemen:

We are enclosing herewith a fully executed copy of the Agreement dated August 29, 1973 for the underground electric and communication services for the above named project.

Yours very truly,

John N. Waterloo

Enclosure

RECORDED
30337

THE DETROIT EDISON COMPANY

1970 Orchard Lake Road

Pontiac, Michigan 48053

August 22, 1973

Bell Development Co.
18911 W. 10 Mile Rd.
Southfield, Michigan 48075

Att: Mr. Bert Keehr

RE: TIFFANY SQUARE CONDOMINIUMS

Enclosed is the original and two copies of the Agreement-Easement Restrictions for the above described project. Please have the original and one copy executed and returned to us. We will have the Agreement executed by Bell and Edison and return a fully executed copy to you. The third copy should be retained by you until you receive the fully executed copy from us.

In order to comply with the recording statutes of the State of Michigan, please have two separate witnesses. The notary can be one of the witnesses. Also, print or type the names of all parties signing the documents, including witnesses, and notary.

Your attention is called to Paragraph No. 3 of this Agreement, whereby you would be responsible for any damages which might occur to the Company's underground lines after installation. It is, therefore, extremely important that not only you, but any contractors working for you, exercise due care to avoid any damage.

Prompt return of these instruments, fully completed, will assist in prompt scheduling of our work to be completed in your project. Please return all documents to: John Waterloo, at 1970 Orchard Lake Road, Pontiac, Michigan 48053.

Yours very truly,

John N. Waterloo

Enclosures

RECORDED RIGHT OF WAY NO. 30337

APPLICATION FOR U.R.D. EASEMENTS

TO: J. ROBERTSON, Supervisor

Date 7-17-73

Real Estate and Rights of Way Dept., OAKLAND District

Application No. _____

For RE & RW Dept. Use - DE-BEL No. CE-3-64

We have included the following necessary material and information:

MATERIAL:

A. Subdivision

- 1. Copy of complete final proposed plat, or
- 2. Recorded plat
 - a. Site plan
 - b. Title information (deed, title commitment, contract, or title search)

or

B. Other than subdivision

- ✓ 1. Property description;
- ✓ 2. Site plan
- ✓ 3. Title information (deed, title commitment, contract or title search)

INFORMATION:

(1) Project name: TIFFANY SQUARE CONDOMINIUM County: OAKLAND

City/Township/Village: SOUTHFIELD Section No. _____

(2) Name of developer: BELL DEVELOPMENT CO. - MR. BERT KEBHL

Address: 18911 W. 10 MILE - SOUTHFIELD Phone No. 358-0110

(3) Date service is wanted 8-15-73

(4) Entire project will be developed at one time: Yes No **4 PHASES**

(5) Cable poles on property: Yes No

(6) Joint easements required: Yes No

(a) Name of other utilities: M.B.T. + CONSUMERS POWER CO.

(b) Other utility engineer names and phone numbers: M.B.T. R. ROWLEY 542-9911

CONSUMERS - R. HEISER 549-5000

(7) Part of subdivision is fed from overhead service Yes No

Lot No. _____

(8) Additional information or comments: _____

NOTE: Trenching letter attached OR, will be submitted later

Signed: [Signature]
(Service Planning Department)

Received, RE & RW Dept. on: 7-23-73

RECORDED RIGHT OF WAY NO.

30337

MEMORANDUM ORDER
FOR GENERAL USE
DE FORM NS 77 12-53

TO Engineering Coordinator Supervisors
Bldg. 4 - Room 250 W.S.C.

DATE 8-31-73 TIME _____

Re: Underground Service - Tiffany Square Condominium, City of Southfield, Oakland County.
Agreements and Easements obtained - OK to proceed with construction.

COPIES TO: J. Baum - Service Planning - P.S.C.

SIGNED

John N. Waterloo
John N. Waterloo
Real Estate and R/W Dept.

REPORT _____

DATE RETURNED _____

TIME _____

SIGNED _____

RECORDS
RIGHT OF WAY NO.
30337

RIW# 30337



2000 Second Avenue
Detroit, Michigan 48226
(313) 237-8000

DATE: July 15, 1976

Mill Apartments Inc.
18911 W. 10 Mile Suite 200
Southfield, Mi

RE: Tiffany Square Apts.

Gentlemen:

Subject to our agreement with you for the installation of underground electric lines in the above project, the Detroit Edison Company will own, install and maintain its electric lines and equipment and provide trenching in easements six feet (6') in width, which will be subsequently platted or provided by a separate easement instrument. Location of the lines and equipment will be as shown on the combined utility plan as approved by you on 6-23-76.

The cost to you for the extension of the underground distribution system consisting of primary and/or secondary main cable (s) is \$ 4,020.00 based on 2,010 trench feet or - lot front feet.

Extra charges in addition to the above will be made if it is necessary to bore under roads or other paved areas and for trenching in water conditions, rocks, rubble or when other practical difficulties in trenching exist.

A winter construction charge of \$ 1.00 per linear foot of trench will be assessed for all trenching you require from December 15 through March 31.

Pursuant to establishing a field construction start date for the above named project, it is necessary that the conditions of the grade in the area of construction be determined. Work cannot start until grade is within 4" of final.

Five days prior to the start of construction that has been scheduled for 8-27-76, we will require receipt of the attached Certificate indicating the completion of grading and payment in the amount of \$ 4,020.00 as a non-refundable Contribution in Aid to Construction for the above charges.

If for any reason, beyond the control of the Utility, the construction start date indicated above is changed, charges will be adjusted to reflect conditions that exist at the time construction is actually started.

RECORDED RIGHT OF WAY NO. 30337

RETURN

Tiffany Square Apts.

Date July 15, 1976

Service laterals necessary to link the above distribution system with individual meters will be billed after their installation and are not part of this agreement.

Installations of main feeder lines that are not covered under the mandatory underground provisions of the Michigan Public Service Commission Rules will be undergrounded only under the terms of a separate agreement.

Extensions of electric distribution facilities to vacant lots or to building sites not ready for service will require refundable construction deposits that will be negotiated in a separate agreement.

Community antenna systems or other cable systems shall not be installed in the same trench with Company and telephone cables without a separate signed agreement.

The future maintenance of our electric lines in the proposed easements does not include repair of damage to our lines and equipment caused by you, your contractors, agents, employees, successors and assignees. If such damage should occur, we will require reimbursement for any such damage.

Notwithstanding anything herein to the contrary, the installation, ownership, and maintenance of electric services and the rates, fees, and charges to be made shall be subject to and in accordance with the orders and rules and regulations adopted and approved from time to time by the Michigan Public Service Commission.

Please sign two of the enclosed copies and return them. You may retain the third copy for your file.

Very truly yours,

Raymond R. Baker
Service Planner

ACCEPTED: MILL APTS, Inc.
Name Harold R. Langer
Title Purchasing Agent
Name _____
Title _____
Date 7/20/76

RB/mg

Enc: Grading Certificate

RECORDED RIGHT OF WAY NO. 30337



2000 Second Avenue
Detroit, Michigan 48226
(313) 237-8000

DATE: July 15, 1976

Mill Apartments Inc.
18911 W. 10 Mile Suite 200
Southfield, Mi

RE: Tiffany Square Apts.

Gentlemen:

Pursuant to establishing a field construction date for the above named project, it is necessary that the conditions of the grade in the area of construction be determined. Work cannot start until this is accomplished.

Please sign and return two copies of the Certificate below. You may retain the third copy for your file.

Very truly yours,

Raymond R. Bokaw
Service Planner

7-16-76
Date

C-E-R-T-I-F-I-C-A-T-E

I/We, the undersigned, hereby certify to the Detroit Edison Company that all grading in utility easements and/or the routes of the underground facilities on the above subject development has been completed within four (4) inches of final grade.

I/We further agree that a stake will be placed at the location of each piece of above grade equipment, indicating the final grade to be achieved. A copy of the Detroit Edison Company underground construction drawing No. A-64668 for this development is in my/our possession and will be used for this purpose.

Mill Apts. Inc.
Name Harold Lampson
Title Purchasing Agent
Name _____
Title _____
Date 7/20/76

RECORDED RIGHT OF WAY NO. 30337

RETURN

R 30 337

RETURN TO
J. A. ROBERTSON
THE DETROIT EDISON COMPANY
30400 TELEGRAPH ROAD, 272 OAKDH
BIRMINGHAM, MICHIGAN 48010

RETURN TO
J. A. ROBERTSON
THE DETROIT EDISON COMPANY
30400 TELEGRAPH ROAD, 272 OAKDH
BIRMINGHAM, MICHIGAN 48010

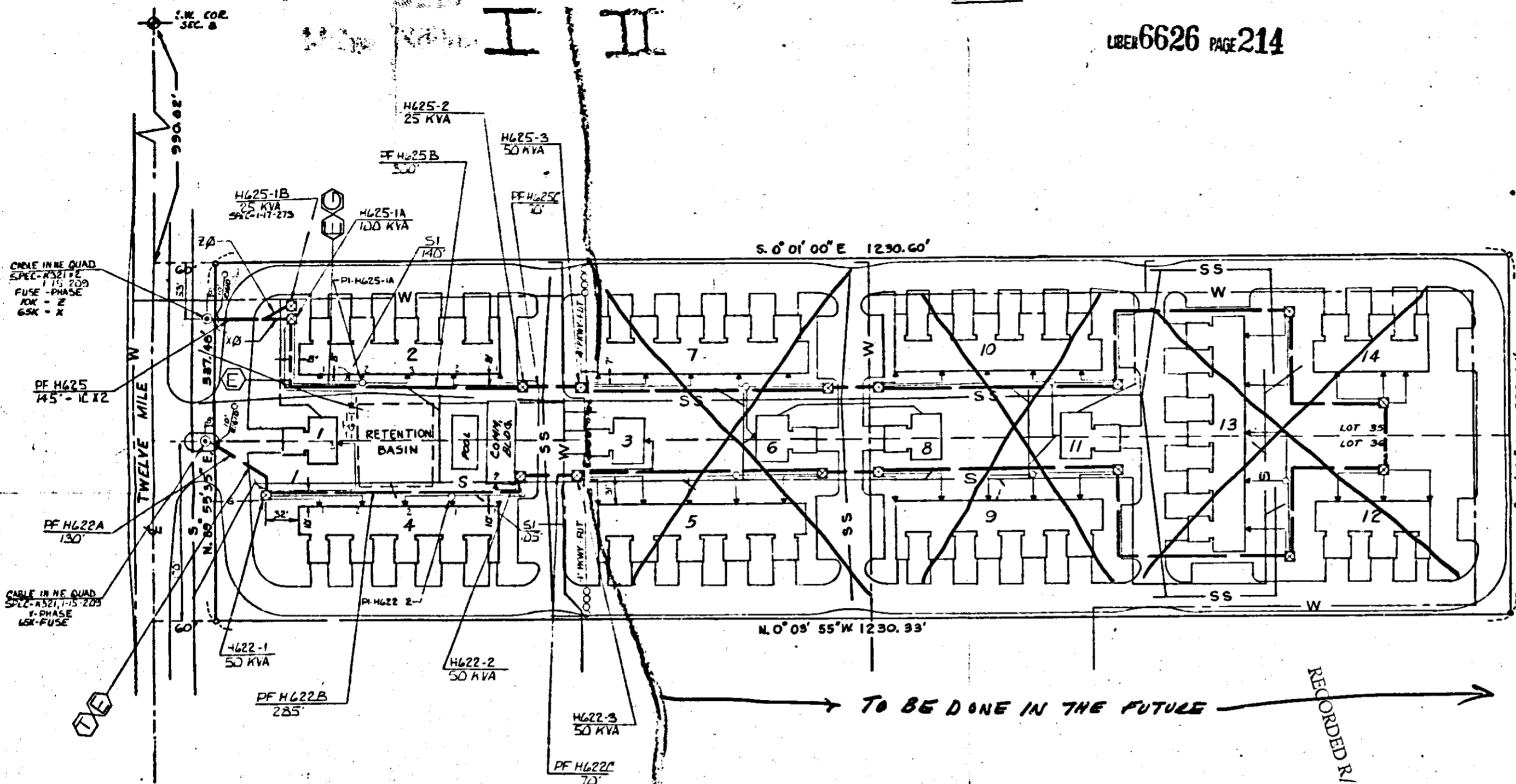

TRANSFORMER DATA

U.D.T. NO.	SIZE	ED. STR. NO.
H622-1	50 KVA	
-2		
-3		
H625-1A	100 KVA	
-1B	25 KVA	
-2	25 KVA	
-3	50 KVA	

TRANSFORMER SPEC: 1-52-37DE-1-17-261
 PEDESTAL SPEC: 1-0-231
 NO. OF PEDESTALS: 2

- CODE -**
- TEMPORARY SECONDARY PEDESTAL
 - DFT (DEAD FRONT TYPE)
 - UDT (NON-SWITCHING-LIVE FRONT TYPE)
 - UDT (SWITCHING-LIVE FRONT TYPE)
 - ← DIRECTION OF TRANSFORMER DOOR OPENING
 - SECONDARY PEDESTAL
 - △ SECONDARY TERMINAL
 - CABLE POLE
 - PRIMARY SWITCH CASINET
 - BURIED PRIMARY CABLE-ALL VOLTAGE
 - BURIED SECONDARY CABLE
 - BURIED SECONDARY SERVICE CABLE
 - DETROIT EDISON TRENCH ONLY
 - TELEPHONE TRENCH ONLY
 - SEWER
 - WATER
 - GAS
 - PROPOSED CONDUIT

CABLE SUMMARY

ITEM	QTY	UNIT	STEP
DRI. FDR	1	24PEC X 1 13.2 KV	713-3028-145
SEC MAINS	1	AP2 350M & 1-4/0 800 V.	713-0627-245
SEC SER	1	AP2 2/0 & 1-01 800 V.	713-0810-105

TRENCH SUMMARY

ITEM	QTY	UNIT	STEP
JOINT USE-MBT-DE-CP	5	585	
D. E. ONLY	1	125	
TEL	1	25	
GAS	1	20	
TOTAL		945	

GPS SHFT: 011
 PHONE NO: 352-3647

- GENERAL NOTES -

TRENCHING TO BE DONE BY C.P.C.O.
 TRENCH AND CABLE LENGTHS ARE APPROXIMATE.
 SEE DRAWING UH-12308 FOR TRANS. MAT. DETAILS.
 SEE PAGE 3211 (S.I.M.) DETAIL "D" FOR ENTRANCE POINT DETAILS (APTS ONLY).
 SEE DRAWING UH-2283 FOR PLACEMENT OF CABLES, TRANSFORMERS AND PEDESTALS (S.W.'S ONLY).
 D.E. SERVICE PLANNER: BEN CONLEY-644-3040 EXT 75-218
 TEL. CO.: B. BOHLEY-542-2211
 C.P. CO.: B. MEISER-542-5000 EXT 233

CONTACT "MISS DIG" (847) 340 BEFORE DOING ANY EXCAVATION.
 EASEMENTS INDICATED BY OUR CENTERLINES ARE SIX FEET IN WIDTH UNLESS OTHERWISE NOTED.

PERMITS REQUIRED
 CITY OF SOUTHFIELD

TO BE DONE IN THE FUTURE

RECORDED R/W FILED 20237

I II

D	C	B	A	REFERENCE	DATE	JOB TITLE
DESIGNED BY	CHECKED BY	APPROVED BY	DATE			
AS-INSTALLED						

TIFFANY SQUARE CONDOMINIUMS
 SW 1/4 OF SW 1/4 SEC. 8
 CITY OF SOUTHFIELD OAKLAND CO. A-63569

THE DETROIT EDISON COMPANY
 SERVICE PLANNING DEPARTMENT
 NUMBER OF UNITS: 108
 ORDER NUMBER: 17847335
 LAYOUT REVISED: 8/23/10
 DIST. THROUGH CIRCUIT: 8823 LANCASTER-102 KV
 DEPT. ORDER NUMBER: A-63569

RECORDED RIGHT OF WAY NO. 30337

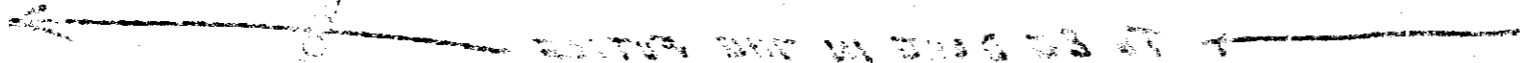

~~30337~~
30337
30337

30337

II

