



Detroit
Edison

CORPORATE REAL ESTATE SERVICES

Job Project No.: XW4172
Location Project No.: BW1222
OCCPT/RX NO.: RX3388D

Date: July 10, 1992
To: Ava D. Thrower
Records Center
From: Michael C. Venetis *MCV*
Subject: Revision of Wire Crossing of Railroad Tracks

Attached are papers related to the notification, dated June 10, 1992, to revise the above-mentioned crossing in the NE 1/4 of Section 7, Taylor Township, Wayne County, Michigan.

Service Planning, Wayne-Monroe Division, is hereby notified to revise the crossing as requested. Note: all work associated with aerial crossings of railroad tracks require advanced notice to the operating railroad.

Please incorporate these papers into Record Center File 30000, p. 15.

Attachments

cc: D. Wakefield

B-4

RECORDED RIGHT OF WAY NO. 30000-15



2000 Second Avenue
Detroit, Michigan 48226
(313) 237-8000

June 10, 1992

Mr. M. D. Manion, Division Superintendent
NS Corporation
P.O. Box 1215
Fort Wayne, IN 46801

Re: Revision of Wire Crossing Notification

Dear Mr. Manion:

This letter is your notice of the planned reconstruction of an overhead wire crossing over your railroad tracks, within the Beech Daly public right of way, by the Detroit Edison Company, in the NE 1/4 of Section 7, Taylor Township, (City of Allen Park) Wayne County, Michigan, as described on the enclosed drawings and information forms.

1. Location: Beech Daly Rd., approximately 1905' south of Ecorse Road.
2. Detroit Edison Project and Crossing Nos.: BW1222, RX3388D
3. This is a reconstruction of an existing crossing. (Previous MPSC Permit No. ED2-8-5582/Agreement date: 7-12-65). Information on this crossing is retained in Edison Row File No. 30000 p. 15.
4. Please indicate your:
 - R.R. Valuation Station No. _____
 - R. R. Mile Post No. _____
 - Will a Flagman or Inspection be required? _____

All construction will be done in accordance with specification of the Michigan Public Service Commission and all applicable codes and laws.

Michigan law requires you to respond within 30 calendar days of the receipt of this notification.) In the event you do not respond within 45 days of the receipt of this letter, our crews will be instructed to begin work.

Please contact me on (313)237-8314 if you have any questions.

Sincerely,

Michael C. Venetis
Real Estate Associate
Room 2310 WCB

cc: Service Planning
Attachments
B7

Certified Mail
Return Receipt Requested

RECORDED RIGHT OF WAY NO. 30000-P15

ATTACH A SKETCH SHOWING THE PROPOSED WIRE LINE CROSSING WITH THE FOLLOWING INFORMATION:

For All Wire Lines:

- Location of wire line crossing (mile post reference).
- Right of way lines.
- Streets and roadways.
- North arrow.
- Center line of all tracks.
- Crossing angle (degrees) between center line of main track and wire line.

For Aerial:

- Distance from center line nearest main track to poles.
- Distance from center line nearest side track to poles.
- Height of lowest wire or cable above top of rail - specify sag, temperature, and voltage (phase to ground).
- Length of crossing span.
- Minimum vertical distance of wire from Railroad communications and/or signal lines.

For Underground:

- Size and character of conduit.
- Depth below base of rail.
- Number of ducts.
- Depth on right of way.

SAMPLE COPY

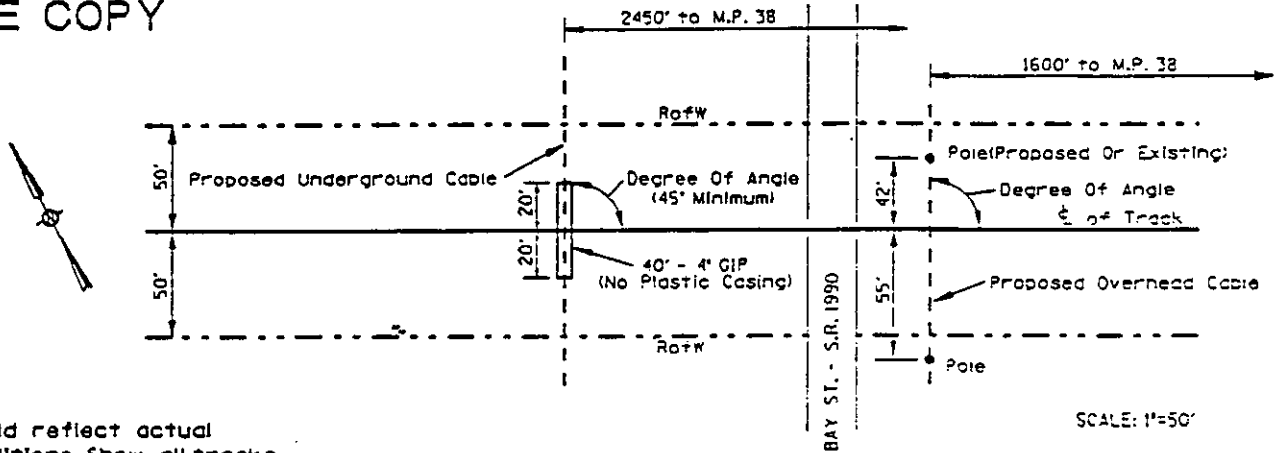

Note:

Plan should reflect actual field conditions. Show all tracks, streets, proposed encroachments, etc.

SITE PLAN

SCALE: 1"=50'

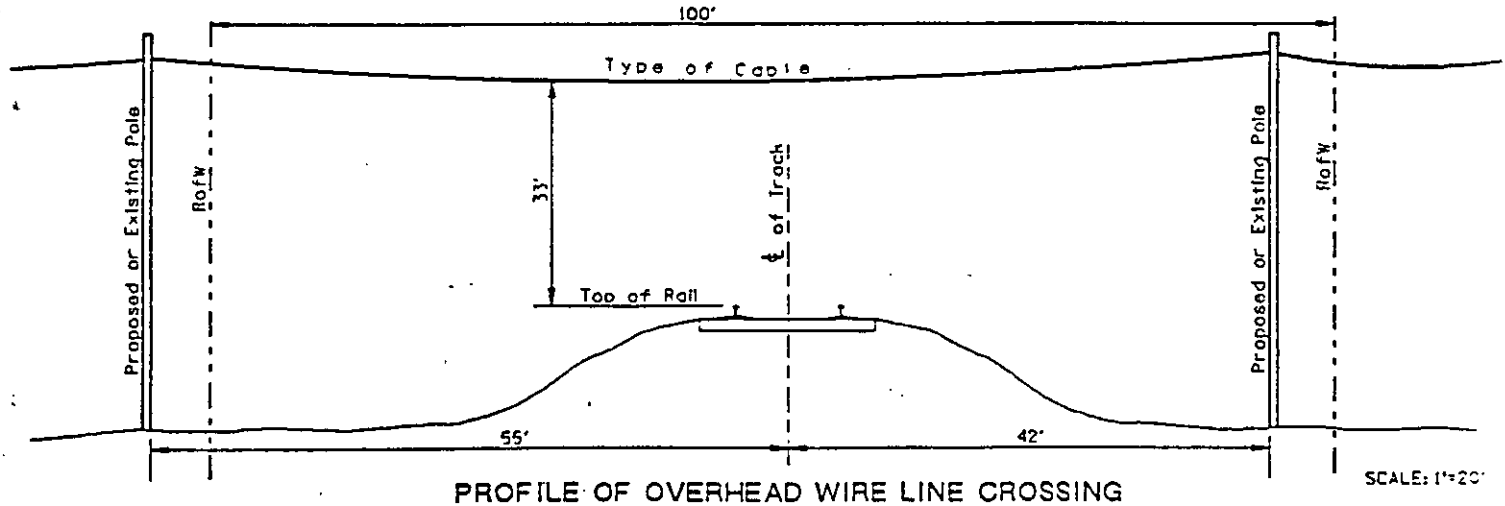

PROFILE OF OVERHEAD WIRE LINE CROSSING

SCALE: 1"=20'

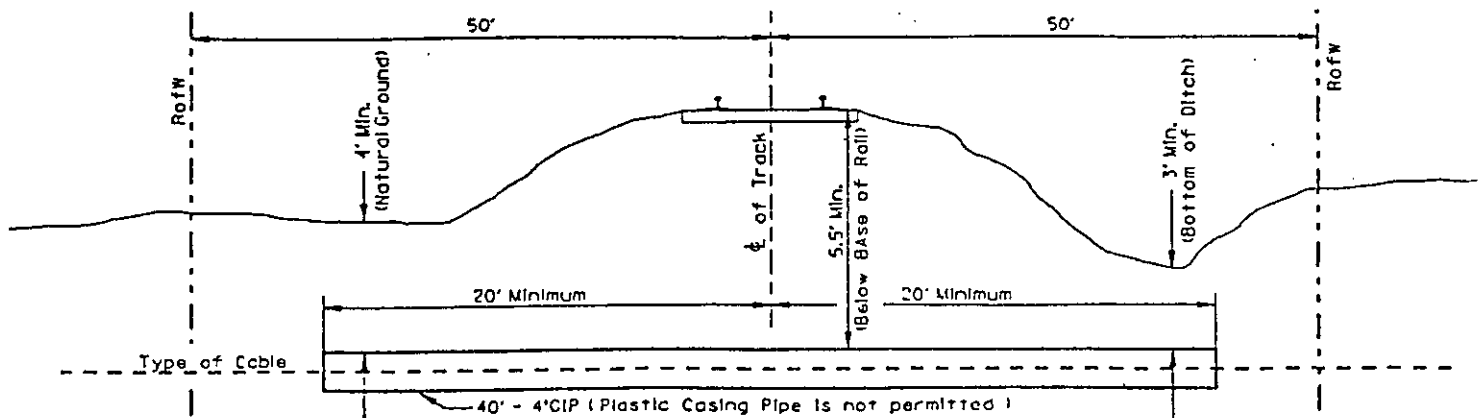

PROFILE OF UNDERGROUND WIRE LINE CROSSING

SCALE: 1"=20'

Note:

Railroad slopes cannot be disturbed. Casing Pipe must extend 2' minimum beyond top of slope or 20' each side of centerline of track, whichever ever is the greatest.

Use Which Applies

APPLICANT MUST ANSWER ALL QUESTIONS AND RETURN THIS FORM TO:

Date Issued: ____/____/____

SUPT. COMPANY STREET CITY, STATE, ZIP PHONE M. D. MANION, DIV. SUPT. NS CORPORATION P.O. BOX 1215 FORT WAYNE, IN 46801

at clearly

1. Legal Name of Applicant (party to agreement): THE DETROIT EDISON COMPANY

2. Mailing Address: Street 3001 HAGGERTY RD. S. City BELLEVILLE State MI Zip 48111

4. Billing Address: Street 3001 HAGGERTY RD. S. City BELLEVILLE State MI Zip 48111

3. Name of Applicant Representative: DAN WAKEFIELD

5. Name of Contact for Billing Purposes:

Title: ASSOC. LINES DESIGNER

Title:

Telephone Number: (313) 397-4345

Telephone Number: ()

- 6. Applicant is a: [] Corporation - Give state of formation: [] Limited Partnership - Give state of formation: [] General Partnership - Give state of formation: [] Sole Proprietorship - Give name of owner: [] Individual [] Government Entity [] Other:

7. Location of Wire Line: A. Nearest Street BEECH DALY RD. B. Nearest Town TAYLOR C. County WAYNE D. State MICH.

E. Railroad Milepost Reference: _____ ft. N E S W of Milepost (circle one)

F. Will wire line be located entirely within confines of public street? [X] Yes [] No

If yes, provide conclusive evidence for verification.

Street width: 120 ft. Street right of way width: 120 ft.

8. Wire Line [] is to be installed [X] already exists and is being upgraded Are there any agreements covering the wireline? [] Yes [] No [X] Do not know

If yes, identify and attach copies:

- 9. The Wire Line will: (check all appropriate boxes) [X] Cross tracks - How many? 2 [X] Cross communication and/or signal lines - Separation 7.5' (ft.) [] Parallel Tracks - Minimum horizontal distance to centerline of adjacent track (ft.) [] Be underground - Depth below base of rail Minimum depth on right of way (ft.) [] Be aerial - Specify for lowest conductor: 39.3 ft. above top of rail, 0 VOLTS phase to ground voltage

10. Identify facilities on Railroad right of way (poles, guy wires, towers, etc.):

11. Type of Wire Line: [] Cable TV [] Telephone [X] Electric Power [] Fiber Optic [] Other (Specify):

12. Specifications of Wire Line: Gauge of Wire: 636 Material of Wire ALUM. Maximum Circuit Voltage (phase to ground): 7.6KV Size and Type of Conduit: Length of Conduit: Cable type and capacity:

13. Define any special specifications of the installation:

14. Provide a drawing of the wire line to be installed. A sample drawing and a list of required information is on the back of this form.

RECORDED RIGHT OF WAY NO.

30000-115



Railroad Crossing Application - Overhead

Please Print

Railroad Name Norfolk & Western R.R.				Department Order C-25315		
Revision From RX No. (Available From Record Center (Ext. 78498)) RX-3388C		New RX No. or R/W No.		Spans		
Location: City/Township Taylor		Town T-38	Range R-10E	County Wayne	¼ Section N.E.	Section 7
Location Description Beech Daly Rd. approx. 1905 ft. South of Ecorse Rd.						

This Crossing:

Is within the public road right-of-way or Is on railroad property Provides service to the railroad (If yes, check box)

Crossing Data

Detailed On Attached Drawing

RX-3388D

Railroad Mile Post (Number)	State Permit No. Existing ED 2-8-5582	Date 04-01-92	Distance to Crossing from Mile Post (in feet) Ft.
-----------------------------	---	-------------------------	---

Existing							Proposed						
Type of Structure							Type of Structure						
<input type="checkbox"/> Wood <input type="checkbox"/> Steel							<input type="checkbox"/> Wood <input type="checkbox"/> Steel						
Conductors				Poles			Conductors				Poles		
Span.	No. Size	Kind	Voltage	Location	Length	Class	Span.	No. Size	Kind	Voltage	Location	Length	Class
A-B	3-636	B	13.2kV										

RECORDED RIGHT OF WAY NO. 30000 T 15

Summary of Line Changes (continue on separate sheet if necessary)

Clearances		
Tolerance	Clearances	Height
Nearest 0.1 foot with lowest conductor or wire at 60° final sag. (If different indicate on drawing)	From Top of Rail to Nearest Wire	39.3 Ft.
	Railroad Communication or Signal Lines	7.5 Ft.

* Materials shall be as noted in the current revision of Detroit Edison's General Specifications for Overhead Line Construction at Railroad Crossings. Actual field dimension may vary from those indicated. However, the clearances shall be in compliance with the current revisions of Order Nos. 1679 and 1868 of Michigan Public Service Commission.

Designed By D. Wakefield	Date 05-18-92	Checked By Frank Weimert	Date 05-18-92
Company Location 115 Wayne-Monroe Div. Hq.	Phone No. 179-4345	Wayne-Monroe Division	

PROPOSED LINE CROSSING OVER NOR. & WESTERN R.R.
IN BEECH DALY RD. APPROX 1905' SOUTH OF
ECORSE RD.

EXISTING PERMIT NUMBER ED2-8-5582
3 MILES S.W. OF CITY OF
CITY OF ALLEN PARK

SECTION 7, NE 1/4 TOWNSHIP TAYLOR (TAY-14) R 35 COUNTY WAYNE

NOTES

MATERIALS SHALL BE AS NOTED IN THE DETROIT EDISON COMPANY'S GENERAL SPECIFICATIONS FOR OVERHEAD LINE CONSTRUCTION AT RAILROAD CROSSINGS DATED MARCH 1955.

ACTUAL FIELD DIMENSIONS MAY VARY SOMEWHAT FROM THOSE SHOWN BUT THE REQUIREMENTS OF ORDER NO. 1679 OF MICHIGAN PUBLIC SERVICE COMMISSION AS REVISED JAN. 1, 1944, WILL BE COMPLIED WITH

MINIMUM CLEARANCES

NEAREST POLE TO RAIL	SIDING	7 FT
	MAIN LINE	12 FT
WIRES OVER TRACKS	0 - 750 VOLTS	27 FT
	750 - 15,000 VOLTS	28 FT
	15,000 - 50,000 VOLTS	30 FT
WIRES OVER R R SIGNAL	0 - 750 VOLTS	2 FT
	750 - 8,700 VOLTS	4 FT
	8,700 - 50,000 VOLTS	6 FT

CONDUCTORS				POLES			
NUMBER	SIZE	KIND	VOLTAGE	LOCATION	LENGTH	CLASS	TYPE
SPAN A-B				A	55	3	WOOD
3	636	B	13,200	B	55	3	"
1	0	B	NEUTRAL	C	40	5	"
				D	45	1	"
				E	40	-	"
				F	45	4	"
				I	40	5	"

CHECKED BY GEPPERT GENERAL ENGINEERING DEPT. DATE 12-11-67

DESIGNED BY L. SHEPARD OVERHEAD LINES DEPT. WAYNE DIST. CO.

SPAN	SPAN LENGTH	LOWEST CONDUCTOR OVER R.R. TRACKS	STRINGING SAG AT 60°F	HEIGHT OF LOWEST CONDUCTOR OVER	
				R.R. TRACKS	R.R. SIGNAL WIRE
A-B	139.2'	#0B NEUTRAL	23"	39.3'	7.5'

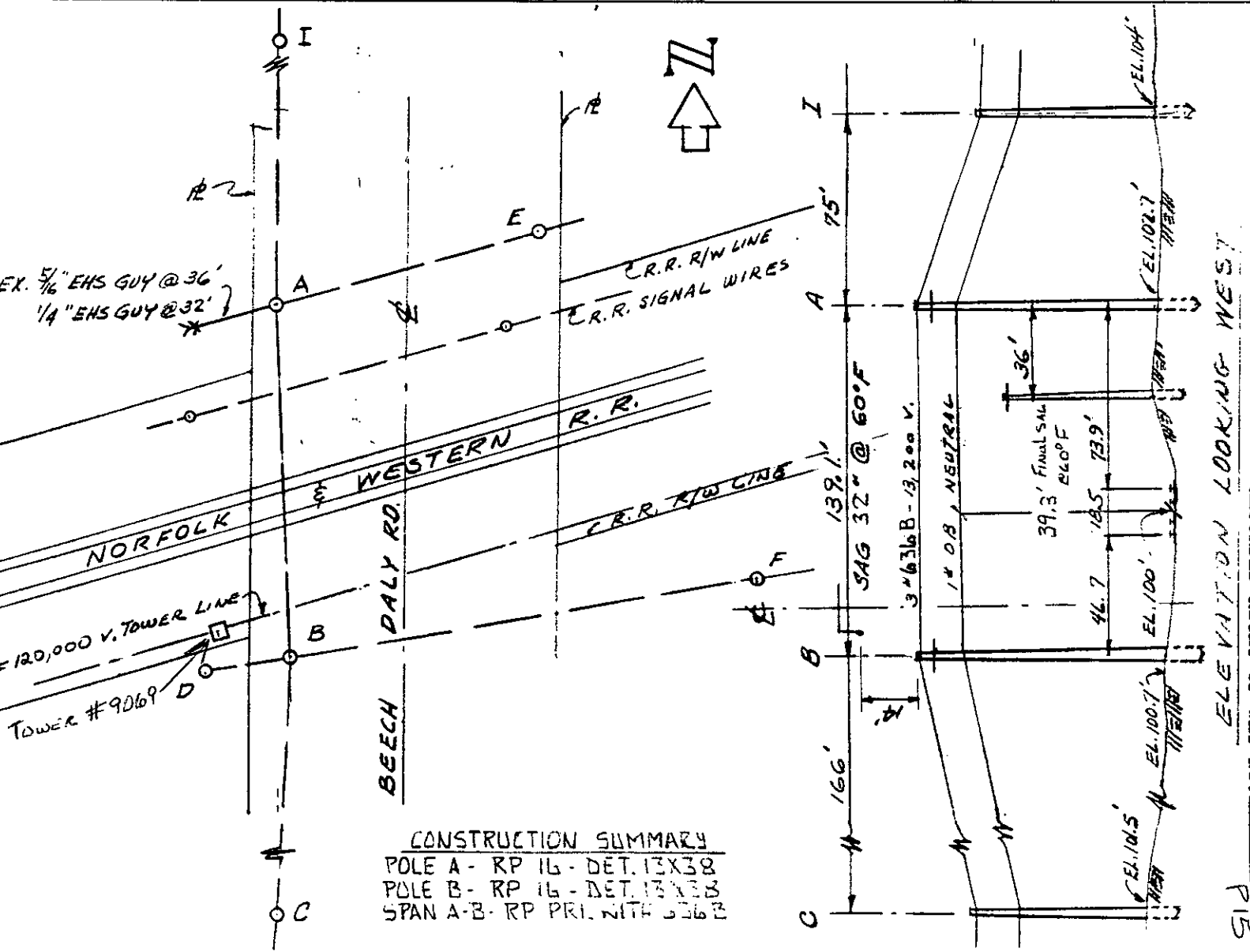

CONSTRUCTION SUMMARY
POLE A - RP 16 - DET. 13X38
POLE B - RP 16 - DET. 13X38
SPAN A-B - RP PRI. WITH 636B

RECORDED RIGHT OF WAY NO. 30000-115
PLAN VIEW LOOKING WEST

MICHIGAN PUBLIC SERVICE COMM.
 PUBLIC UTILITIES DIVISION
 TELEPHONE WOODWARD 2-2100

Te. _____ Gas _____
 Elec. _____ R & S _____

Adm. _____
 File _____

JAN 3 1968

THE DETROIT EDISON COMPANY

2000 SECOND AVENUE
 DETROIT 26, MICHIGAN

December 11, 1967

Michigan Public Service Commission
 Lansing 13, Michigan

Gentlemen:

The Detroit Edison Company, Detroit, Michigan, hereby makes application for authority to string the following wires over the tracks of the Norfolk and Western Railroad approximately 3 miles southwest of the City of Allen Park, NE 1/4 of Section 7, Taylor Township, Wayne County, Michigan.

Span A - B

Three #0-A - 13,200 volt wires and one #0-B neutral wire over the tracks of the Norfolk and Western Railroad located in Beech Daly Road at a point approximately 1905' south of the centerline of Ecorse Road.

NOTE: New permit requested due to a change in the length of the crossing span and to a new height over tracks.

The proposed wire crossing will be constructed in accordance with specifications of the Michigan Public Service Commission and the construction standards of The Detroit Edison Company, approved by the Michigan Public Service Commission on July 19, 1939, File ED 2-9.01.

- Enclosed is a waiver of hearing granted by the Railroad Company. (12-18-67)
- Waiver of hearing by the Railroad Company is covered by blanket waiver.
- This application covers reconstruction of existing crossing and will cancel and supersede wire crossing permit No. ED 2-8-5582 dated 7/12/65
- This is a new crossing.

Reference number of construction drawing is RX- 3388C.

Railroad File No. 9874 K

Yours very truly,

Permit No. ED2-8-6154
 Date 1-3-68
 By J M Hoppe

I. W. Gamble
 I. W. Gamble
 Supervisor of Rights of Way
 Properties and Rights of Way Dept.

RECORDED RIGHT OF WAY NO.

30000
 9/9

Check in circle indicates statement applicable.



Norfolk and Western Railway Company

SIGNALS AND COMMUNICATIONS DEPARTMENT

ROANOKE, VIRGINIA 24011

WILLIAM B. VAN LEAR
MANAGER SIGNALS AND COMMUNICATIONS

December 18, 1967
Ry. File 9874 K
(Hand, Mich.)

I. W. GAMBLE
IW
DEC 27 1967

PROP. & R/W DEPT.

Mr. I. W. Gamble, Supvr. R/W
Properties & Rights of Way Dept.
The Detroit Edison Company
2000 Second Avenue
Detroit, Michigan 48226

Dear Mr. Gamble:

This refers to your letter dated December 12, File EL-3388C, requesting waiver of hearing on your proposed revision of 13.2 KV crossing of Norfolk and Western Railway, entirely within the confines of Beech Daly Road, Hand, Michigan.

The Norfolk and Western Railway does not desire representation at this hearing to determine the necessity for revision of said crossing.

Your proposal has been checked and no objections are seen to the revision of this crossing on condition that your Company will relieve the Norfolk and Western Railway of all expense and legal liability during the reconstruction, that the crossing will be so constructed and so maintained as to comply with all code requirements governing, in a manner satisfactory to this Company and so as not to interfere with the maintenance and operation of this Company.

Please notify Mr. D. E. Turney, Division Engineer for the Norfolk and Western Railway, located at Ft. Wayne, Indiana, a few days ahead of the time you start to work across our tracks.

Yours very truly,

W B Van Lear
Manager Signals & Communications

5MM/bwh

cc: Mr. D. E. Turney, Div. Engr., Ft. Wayne, Ind. - W/Attach.

RECORDED RIGHT OF WAY NO.

30000
9/15

THE DETROIT EDISON COMPANY

2000 SECOND AVENUE

DETROIT, MICHIGAN 48226

TO:

December 12, 1967

Mr. J. G. Karlet, Manager
Signals and Communications
Norfolk and Western Railway Company
8 North Jefferson Street
Roanoke, Virginia 24011

Proposed Overhead Wire Crossing:

Three #0-A - 13,200 volt wires and one #0-B neutral wire Span A-B.

New permit requested due to a change in the length of the crossing span and to a new height over tracks.

Specific Location

In Beech Daly Road at a point approximately 1905 feet south of the centerline of Ecorse Road, approximately 3 miles southwest of the City of Allen Park.

R. R. Valuation Station _____ R. R. Mile Post _____

City/Village _____ Township Taylor, N.E. 1/4 Section

County Wayne Detroit Edison Plan Attached RX-3388 C

This is a New Crossing _____ This is a Reconstruction of Existing Crossing X

Previous Agreement Information (if any) Date _____ (R. R. Plan) _____

Previous Waiver of Hearing dated 6-23-65 File No. L-Detroit.

Blanket Waiver of Hearing Covers _____ Waiver of Hearing Requested In duplicate.

(Waiver of Hearing to be mailed to applicant listed below)

All construction will be done in accordance with the rules and regulations of the Michigan Public Service Commission.

I. W. Gamble JVS
I. W. Gamble, Supervisor of Rights of Way
Properties and Rights of Way Department

RECORDED RIGHT OF WAY NO. 30000
975

PROPOSED LINE CROSSING OVER NORFOLK & WESTERN R.R. E. STRINGING PERMIT NUMBER ED2-8-5582
 IN BEECH DALY RD. APPROX 1905' SOUTH OF 3 MILES S.W. OF CITY OF
ECORSE RD. CITY OF ALLEN PARK

SECTION 7, NE 1/4 TOWNSHIP TAYLOR (TAY-14) R 35 R 10E COUNTY WAYNE

NOTES

MATERIALS SHALL BE AS NOTED IN THE DETROIT EDISON COMPANY'S GENERAL SPECIFICATIONS FOR OVERHEAD LINE CONSTRUCTION AT RAILROAD CROSSINGS DATED MARCH 1955.

ACTUAL FIELD DIMENSIONS MAY VARY SOMEWHAT FROM THOSE SHOWN BUT THE REQUIREMENTS OF ORDER NO. 1679 OF MICHIGAN PUBLIC SERVICE COMMISSION AS REVISED JAN. 1, 1944, WILL BE COMPLIED WITH

MINIMUM CLEARANCES

NEAREST POLE TO RAIL	SIDING	7 FT
	MAIN LINE	12 FT
WIRES OVER TRACKS	0 - 750 VOLTS	27 FT
	750 - 15,000 VOLTS	28 FT
	15,000 - 50,000 VOLTS	30 FT
WIRES OVER R R SIGNAL	0 - 750 VOLTS	2 FT
	750 - 6,700 VOLTS	4 FT
	6,700 - 50,000 VOLTS	6 FT

CONDUCTORS				POLES			
NUMBER	SIZE	KIND	VOLTAGE	LOCATION	LENGTH	CLASS	TYPE
SPAN A-B				A	55	3	WOOD
3	0	A	13,200	B	55	3	"
1	0	B	NEUTRAL	C	40	5	"
				D	45	1	"
				E	40	-	"
				F	45	4	"
				I	40	5	"

CHECKED BY GEPPERT GENERAL ENGINEERING DEPT. DATE 12-11-67
 DESIGNED BY L. SHEPARD OVERHEAD LINES DEPT. WAYNE DIST. OFF.

SPAN	SPAN LENGTH	LOWEST CONDUCTOR OVER R.R. TRACKS	STRINGING SAG AT 60°F	HEIGHT OF LOWEST CONDUCTOR OVER	
				R.R. TRACKS	R.R. SIGNAL WIRE
A-B	139.2'	#0B NEUTRAL	23"	39.3'	7.5'

