

November 20, 2008

Michigan Electric Transmission, an ITC Company
C/O Fernando Guevara
27175 Energy Way
Novi, MI 48377

Attention: Fernando Guevara, Property Management Specialist

SUBJECT: Three Phase, 4800 Volt Distribution line
Reference No: 1001089044/Fraser Twp/Bay County/Allard

REFERENCE: Amended and Restated Easement Agreement (the
"Agreement") dated April 29, 2002, between Consumers
Energy Company ("Consumers") and Michigan Electric
Transmission Company, now Michigan Electric
Transmission Company, LLC ("METC")

Pursuant to Section 7.1 of the Agreement, Consumers hereby notifies METC that Consumers intends to construct underground service on certain land in which METC has an interest under the Agreement. The location of the land on which said line will be constructed, and a further description of the intended use, are set forth-on "Annex A", attached to this letter.

Under said Section 7.1 of the Agreement, METC must within 30 days of this notice notify Consumers, as "Initiating User," of whether or not METC approves the proposed use as a Compatible Use. If you do not notify us either way within 30 days of this notice, then, as provided in said Section 7.1, METC will be deemed to have approved the proposed use as being a Compatible Use. We would appreciate, however, receiving METC's express approval of the proposed use as being a Compatible Use as soon as possible so that we can start work without delay.

November 20, 2008

Page Two

Reference No: 1001089044/Fraser Twp/Bay County/Allard

This letter is being sent to you in duplicate. If METC agrees that the proposed use is a Compatible Use, please indicate that by signing and returning a copy of this letter to us as soon as possible, so that we can immediately proceed with construction. The other copy is for your records.

Very truly yours,



Stacie Lahr
Consumers Energy
One Energy Plaza
Jackson, MI 49201

APPROVED:

MICHIGAN ELECTRIC TRANSMISSION
COMPANY, LLC

By: _____

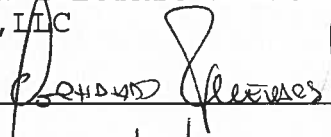

Date: _____

12/10/2008

ANNEX A

Reference No: 1001089044/Fraser Twp/Bay County/Allard

LAND TO BE IMPACTED:

Land located in the Township of Fraser, County of Bay, State of Michigan, described as follows:

That part of the Northeast 1/4 of Section 21, Township 16 North, Range 4 East, South of Kitchen Rd and West of Mackinaw Rd.

PROPOSED USE:

Underground service would cross under transmission line and serve a new house (address #1452). See attached 391 form and sketch.

Prepared by:
Stacie M Lahr 11/20/08
Consumers Energy Company
EP7-436
One Energy Plaza
Jackson, MI 49201



Date: December 9, 2008

To: Fernando Guevara
Real Estate and Rights of Way
ITC

From: David G. Doubley
Engineering
ITC

Subject: **UBA081573/CU-369**
Three Phase 4800V. Underground Service to House
Section 21, Fraser Twp, Bay County

This request is approved.

Approved By



David Doubley
Staff Engineer



Real Estate and Claims Division

**Project No: UBA081573
CU-369**

Date: December 3, 2008

To: David Doubley

From: Fernando Guevara
Real Estate

Subject: Three Phase, 4800 Volt Distribution Line
CE Reference No. 1001089044/Fraser Twp/Bay County/Allard

The attached request was received from Consumers Energy Company. CE is proposing a three phase, 4800 Volt distribution line. The underground service would cross under transmission line and serve a new house. Furthermore, pursuant to the Amended and Restated Easement Agreement, METC/ITC needs to submit a response letter to CE by **January, 3 2009**

Please review and return to my attention with your recommendations/comments.

Attachments

CONSUMERS ENERGY
**NOTIFICATION OF PROPOSED LINE CONSTRUCTION
REQUIRING COORDINATION WITH HVD AND/OR TRANSMISSION LINES**

Send two (2) copies to:

HVD Lines Design and Standards

Att: Vangie Harvey

Jackson, Michigan

TO BE FILLED IN BY SYSTEM OWNER / ENGINEER / CES
Headquarters <u>Bay City</u>
Notification No. <u>1001089044</u>
Date <u>11/5/08</u>

PROPOSED DISTRIBUTION CONSTRUCTION

Sketch Attached Yes No

Primary:

Voltage 4800 Phase Z

No. of Wires _____ Crossarms Per Pole _____

Wire Size _____ Length of Crossarms _____

Distance Below Transmission Offset, West of Transmsn

Skip-Span Yes No

Secondary:

No. of Wires _____ Wire Size _____

Other Details: UG Service

PROPOSED COMMUNICATION CONSTRUCTION TO BE FILLED IN BY FIELD TECHNICIAN
Cable Dia. _____
Weight/ft. _____
Strand Size _____
Tension _____
Pole Attachment Height _____
Map # _____ Pole # _____

EXISTING DISTRIBUTION FACILITIES

Description: 40ft pole south-west of pole #4405 would be my take-off pole for the underground service which would cross under the transmission line and serve a new house (address #1452). Joint UG gas and elect. services typically are trenched in 18"-24" deep; but I can specify deeper if you require it.

LOCATION

Township Fraser

County Bay

Town 16 Range 54 Section 21

Transmission Line Involved #50, East Tawas-Cottage Grove

Transmission Pole No. 4405

TO BE FILLED IN BY HVD LINES DESIGN AND STANDARDS OR METC
Clearance/Attachment Approved <input type="checkbox"/>
Clearance/Attachment NOT Approved <input type="checkbox"/>
Clearance requires further verification with Power System Analysis <input type="checkbox"/> Yes <input type="checkbox"/> No
Structural Integrity - Engineering Required <input type="checkbox"/> Yes <input type="checkbox"/> No
Calculated assuming STE rating of _____ °F Cond Temp
Checked By _____ Date _____
Order No. _____

METC

REMARKS:

Prepared By Brian Allard - CES
System Planning and Performance / Electric Service

Date 11/05/08

Reviewed By Evangeline Harvey
HVD Lines Design and Standards

Date 11/18/08

Reviewed By _____

Date _____

METC

METC lines are subject to the easement rights of METC. Your request has been forwarded to Real Estate for processing and will require a 30-day period prior to approval.

ADDRESS	
1452 Kitchen Rd	
PROJECT TITLE	
1452 Kitchen Rd	
DESIGN NUMBER	
10042367	
CONSTRUCTION MEASURE NUMBER	
100000220615	
NOTIFICATION NUMBER	
1001089044	
ORDER TYPE	
ECNC	
MAINTENANCE ACTIVITY TYPE	
NSU	
METER ORDER NUMBER	METER NUMBER
READ	METER LOCATION
<input type="checkbox"/> SET <input type="checkbox"/> REMOVE <input type="checkbox"/> EXCHANGE	
DESIGNED BY	DATE
BJALLARD	11/05/08



A CMS Energy Company SERVICE

SERVICE SKETCH TITLE BLOCK
 Form 2804 05-12-2008
 11/18/2008 9:43:40 AM d:\o\wrod\ustn\tempdgn\10042367\10042367.001

STEADY STATE DROP - 2.14V
 FLICKER DROP - 4.77V
 MAJOR LOAD - 3 TON A/C

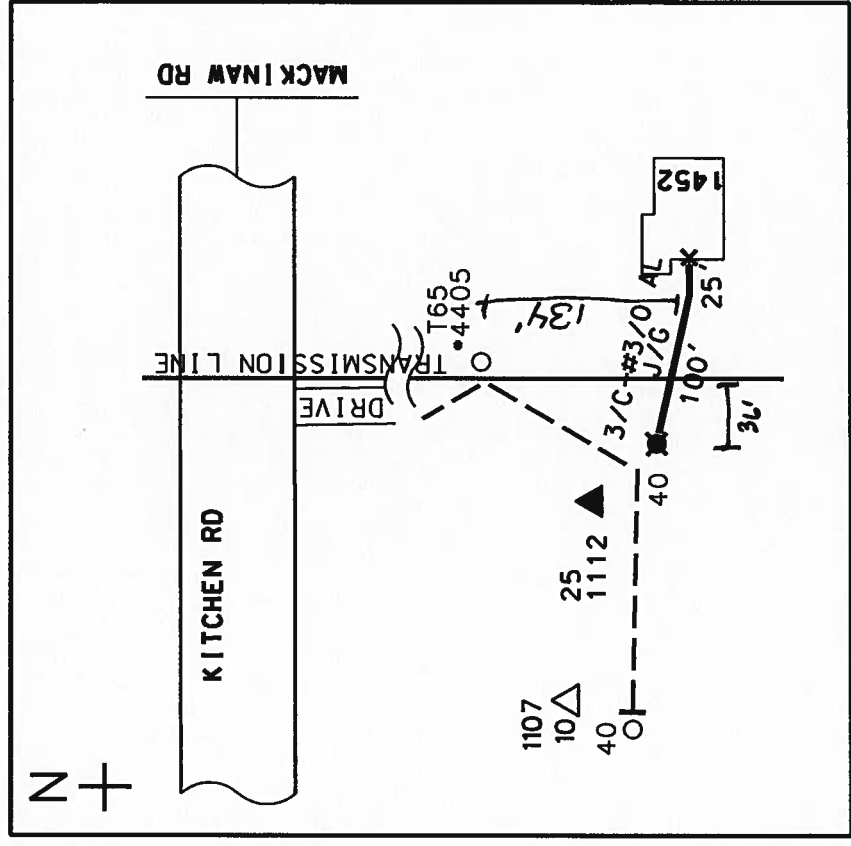

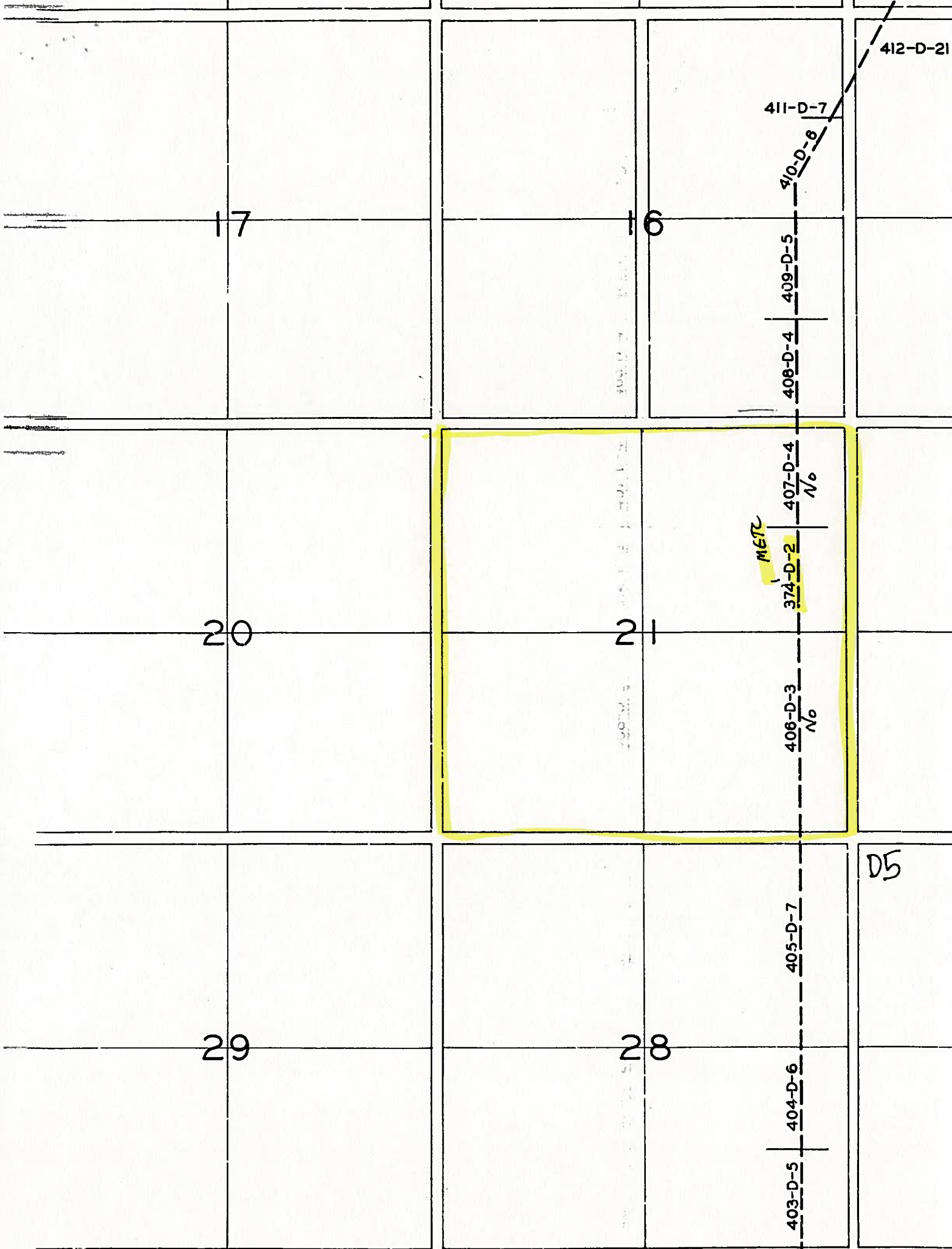

412-D-21

411-D-7

410-D-6

17

16

409-D-5

408-D-4

20

21

407-D-4

No

METC

374-D-2

406-D-3

No

29

28

405-D-7

404-D-6

403-D-5

D5

FRASER

T.16N.-R.4-5E. 25

SEE PAGE 29

