

October 23, 2006

Michigan Electric Transmission Company, LLC
C/O NSI Consulting & Development, Inc.
26657 Woodward Ave., Suite 100
Huntington Woods, MI 48070

Attention: Executive Vice President and Chief Operating Officer

SUBJECT: Three Phase, 11,000 Delta
Reference No: 06606555/Arenac/Arenac/Walker

REFERENCE: Amended and Restated Easement Agreement (the "Agreement") dated April 29, 2002, between Consumers Energy Company ("Consumers") and Michigan Electric Transmission Company, now Michigan Electric Transmission Company, LLC ("METC")

Pursuant to Section 7.1 of the Agreement, Consumers hereby notifies METC that Consumers intends to construct a distribution line across certain land in which METC has an interest under the Agreement. The location of the land on which said line will be constructed, and a further description of the intended use, are set forth on "Annex A", attached to this letter.

Under said Section 7.1 of the Agreement, METC must within 30 days of this notice notify Consumers, as "Initiating User," of whether or not METC approves the proposed use as a Compatible Use. If you do not notify us either way within 30 days of this notice, then, as provided in said Section 7.1, METC will be deemed to have approved the proposed use as being a Compatible Use. We would appreciate, however, receiving METC's express approval of the proposed use as being a Compatible Use as soon as possible so that we can start work without delay.

October 23, 2006

Page Two

Reference No: 06606555/Arenac/Arenac/Walker

This letter is being sent to you in duplicate. If METC agrees that the proposed use is a Compatible Use, please indicate that by signing and returning a copy of this letter to us as soon as possible, so that we can immediately proceed with construction. The other copy is for your records.

Very truly yours,

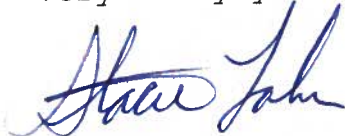

Stacie Lahr
Consumers Energy
One Energy Plaza
Jackson, MI 49201

APPROVED:

MICHIGAN ELECTRIC TRANSMISSION
COMPANY, LLC

By: _____



Date: _____

11/27/2006

Property No: 06606555/Arenac/Arenac/Walker
Parcel ID: 14-01-01-001
Consumers Energy
EPT-430
One Energy Plaza
Jackson, MI 49201

138LN

**NOTIFICATION OF PROPOSED LINE CONSTRUCTION
REQUIRING COORDINATION WITH TRANSMISSION LINES**

Send two (2) copies to:

Transmission Lines Design and Standards

Att: JUSTIN LANCASTER

Jackson, Michigan

TO BE FILLED IN BY SYSTEM OWNER / ENGINEER / CES

Headquarters Bay City

Work Order No. 06606555

Date 10-17-2006

PROPOSED DISTRIBUTION CONSTRUCTION

Sketch Attached Yes No

Primary:

Voltage 11,000 DELTA Phase 3

No. of Wires 3 Crossarms Per Pole 1

Wire Size 1/0 ACSR Length of Crossarms 8

Distance Below Transmission ESTIMATED AT 22 FT UNDER 138KV LINE 60 DEG. NO ICE

Skip-Span Yes No

Secondary:

No. of Wires _____ Wire Size _____

**TO BE FILLED IN BY TRANSMISSION LINES DESIGN
AND STANDARDS OR METC**

Engineering Required Yes No

Checked By _____ Date _____

GWO No. _____

Other Details: SET 40' POLE 20 FEET WEST OF NEAREST OF 138 LINE. Distace measured on grade at right angle from under transmission line to new pole location is 23 feet. DISTRIBUTION WILL ATTACH ON NEW POLE AT 25 FT. CROSS UNDER 138 LINE AT 22 FT . Nearest and lowest 138 line is on west side of tower structure. Grade level distance from nearest tower located to the north of proposed crossing is 105 ft when standing under transmission line.

EXISTING DISTRIBUTION FACILITIES

Description: EXISTING 35-6 POLE - ATTACH DISTRIBUTION ARM AT 24 FT ABOVE GRADE. EXTEND NEW DISTRIBUTION LINE 90 FEET TO NEW POLE . SAG IN NEW LINE WILL BE 2.5 FEET.

LOCATION

Township ARENAC County ARENAC

Section 15 Range 05 east (55)

Transmission Line Involved IOSCO KARN METC Line

Transmission Pole No. SPAN BETWEEN - TOWER #227 AND FIRST TOWER NORTH. loacted where line crosses US -23 in Omer, MI.

REMARKS: If the requested installation is not feasible please advise closest location for 40 foot pole on west side of this 138 line. We have a clearance problem that requires immediate correction. Thanks, Sue

Prepared By Susan Walker Date 10-17-2006
System Planning and Performance / Electric Service

Approved By _____ Date _____
Transmission Lines Design and Standards

Approved By _____ Date _____
METC

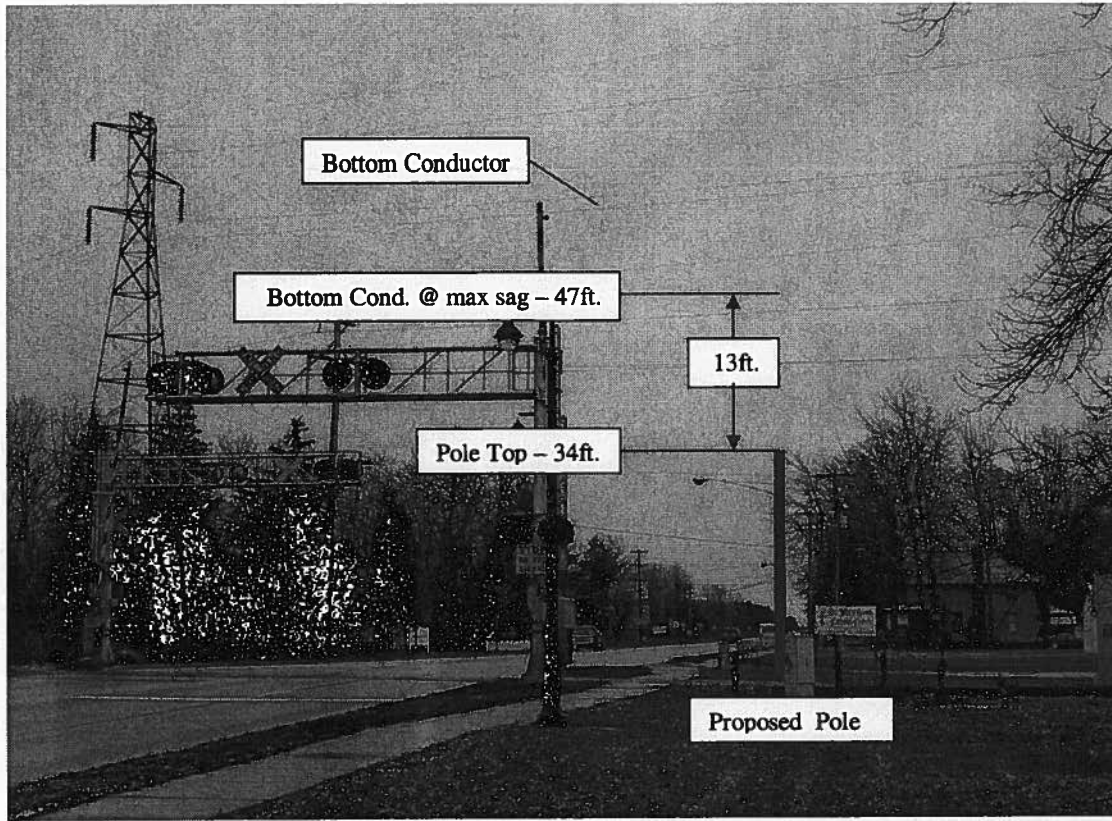

SEE PAGE 21

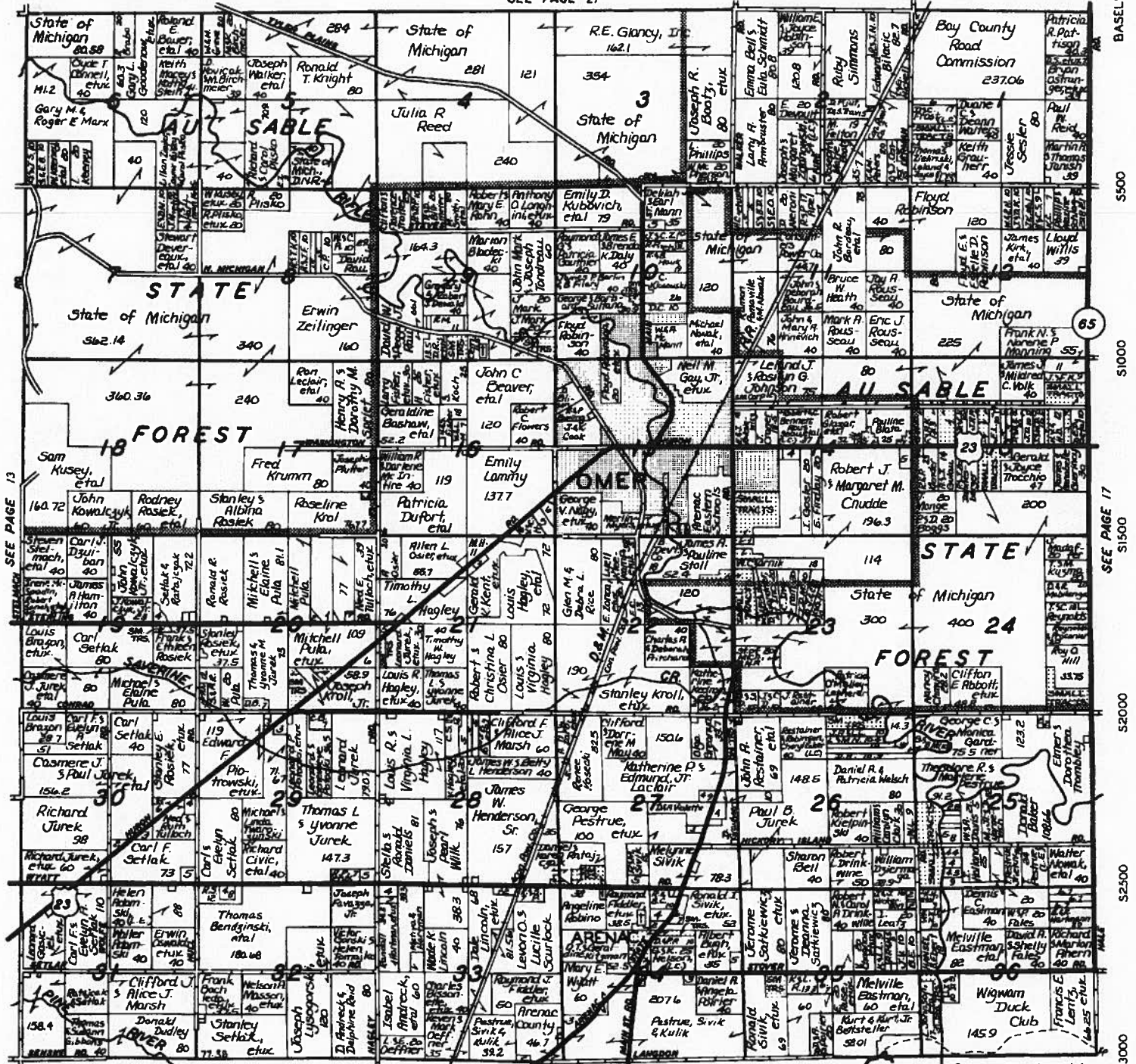

© 1955 Rockford Map Publs., Inc.

SEE PAGE 11

W3000 W2500 W2000 W1500 W1000 W500 BASELINE

OMER CROSSING

LOCATIONS OF NEW DISTRIBUTION POLE AND LINES TO NEAREST EXISTING 138KV LINE



ARENAC CO
ARENAC TWP
T19 R55 SEC.15

HURON RD

ARENAC STATE RD

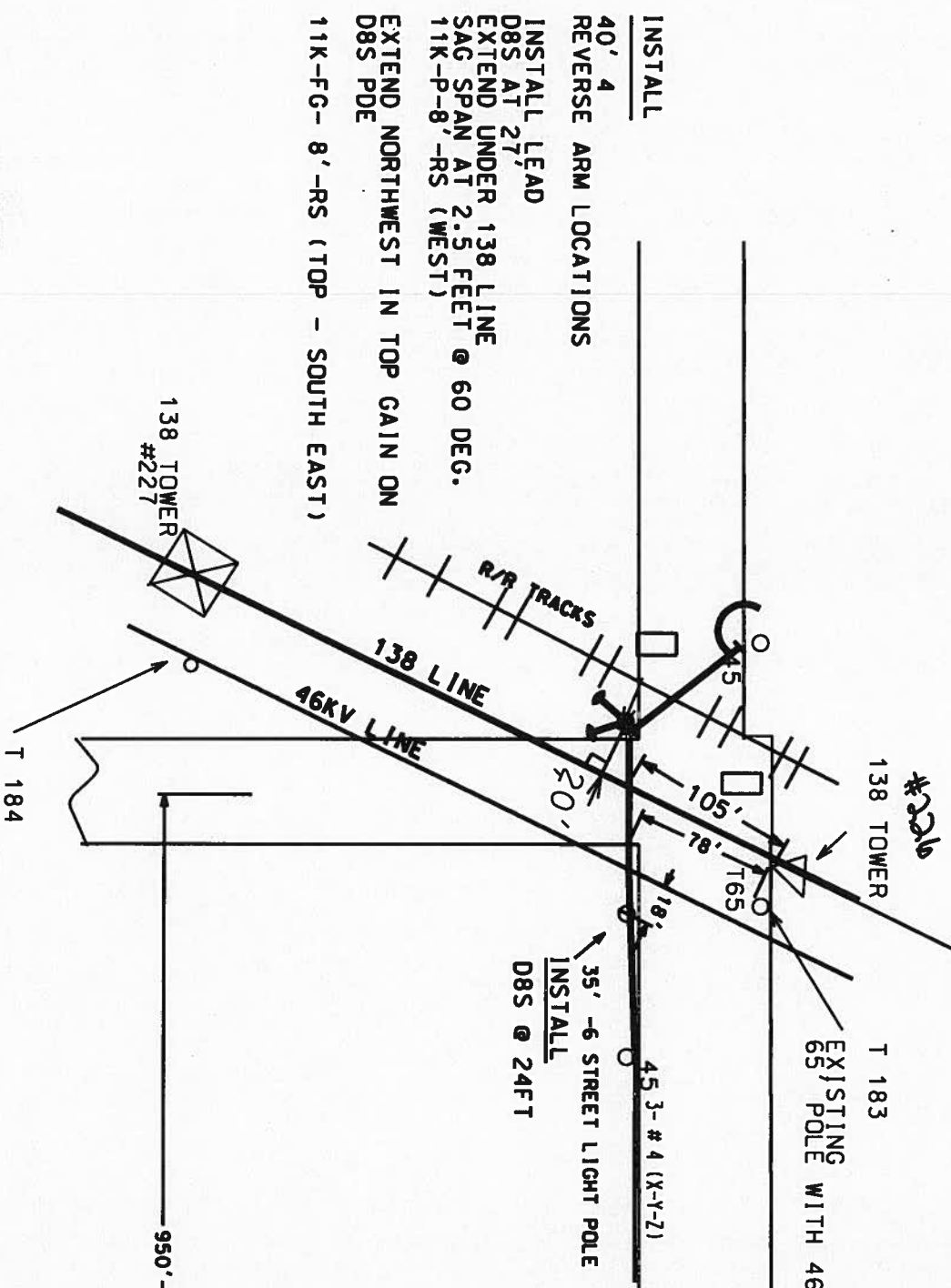

EXISTING POLE VERTICAL CONSTRUCTION 46KV LINE

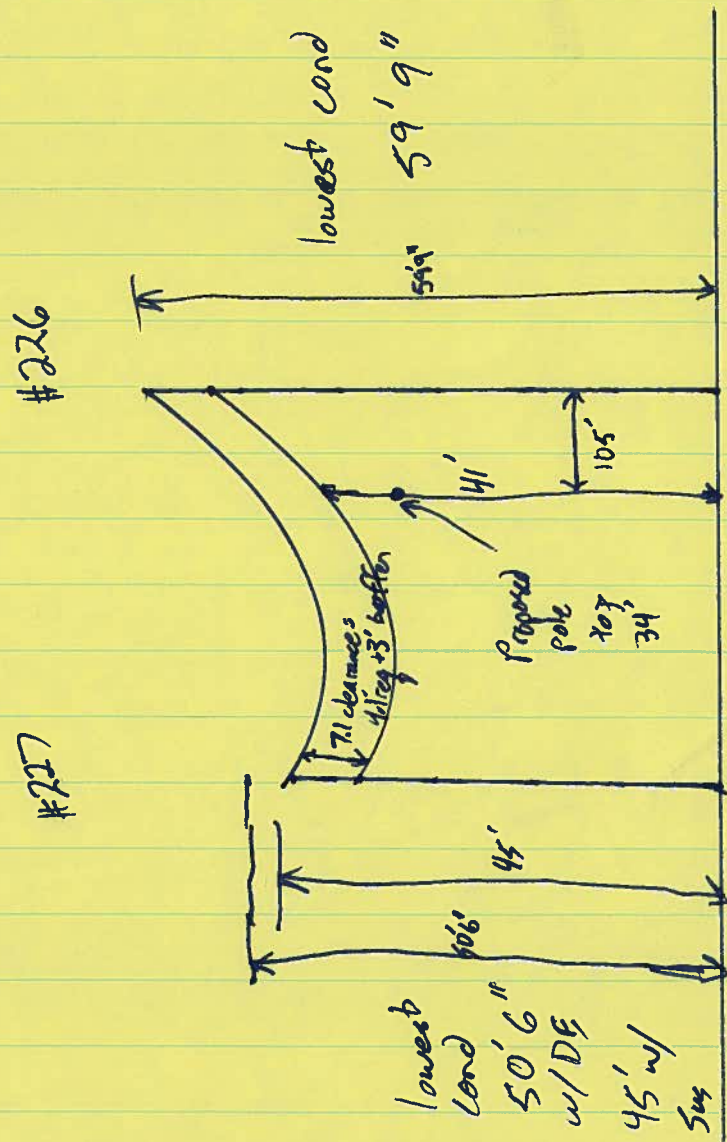
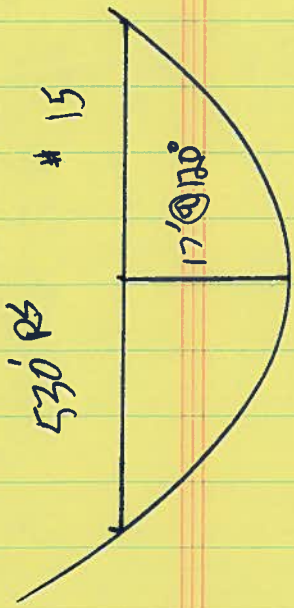

 10/20/06

LINE NAME : DUQUITE-TWINING

UNIQUE STRUCT #: T0008875 ORDER : 53

LINE NO/LTR:	005N
STRUCT #:	226
OP VOLTAGE:	138
STN/EQ :	2198.12
BACK SPAN::	501.00
DEFLECTION:	
TYPE:	TOWER
TOWER TYPE:	LD34
TOWER EXTEN:	

STRUCTURE

DWG: SH: FIG: REV:

ANCHOR SPECIAL CONST:

ANCHOR BRACKET 1: ANCHOR BRACKET 2:

REMARKS:

GUYING:

CONDUCTORS:

LINE	005N	CKT	1	LINE	CKT
SIZE:					
DES VOLTAGE:				SH	FIG REV
DWG:					
SAG DWG:					
JMPR STR DWG:					
DAMPERS DWG:					
SPACER DWG #:					
SPACER RMKS:					

REMARKS:

CKT 1:
SUSP.

CKT 2:

ELEVATIONS

GROUNDLINE:
SETTING:
CENTERLINE:

ERECTION

DWG:
SH: FIG: REV:

DETAIL

DWG:
SH: FIG: REV:

BOM

DWG:
SH: FIG: REV:

FOUNDATION

DWG:
SH: FIG: REV:

ANCHOR

DWG:
SH: FIG: REV:

PLAN & PROFILE

DWG:
SH: FIG: REV:

RWA

DWG:
SH: FIG: REV:

CWA

DWG:
SH: FIG: REV:

GROUND WIRE:

LINE	005N	CKT	1	LINE	CKT
SIZE:	5/16	GALV	STEEL	SH	FIG REV
DWG NO:	MZ0002722				
SAG DWG #:	MZ0001114				
DAMPERS DWG #:					

REMARKS:

CKT 1:
SAG NOTE: FROM 175 (2459.17) TO 284 (1900.42) SAG 5/16" STEEL GRD WIRE PER MZ0001114, 500'RS, 2516#MT. INSTALL KV-93 GW PEAK PER ZM-550 (0-00' - 2 1/2'). SUSP.
CKT 2:

GENERAL REMARKS

REMOVE TRANSPOSITION & OLD TOWER #1224 (KK-71) STA 2044.87

LINE LOCATION

PROP OWNER: CP CO
COUNTY:
REMARKS: VILLAGE OF OMER

PARCEL NO:
SECTION:
TOWNSHIP:
TOWN/RANGE:

REVISION

LETTER: B MWO NO:
GWO: DATE: 6/6/1977
RS NO: DESIGNER:
NOTES:
CORRECTED LINE NAME IN REMARKS FOR RECORD (RLM)
LHW

PREPARED BY: BJC
DATE: 9/2/1964
APPROVED BY: WAC
DATE: 9/14/1964
DEPT. HEAD: BD BUGBEE
DIVISION HEAD: RG COTTRELL

LINE NO/LTR: 005N
STR ORDER: 53
STRUCT #: 226

LINE NAME : DUQUITE-TWINING

UNIQUE STRUCT #: T0008876 ORDER : 54

LINE NO/LTR:	005N
STRUCT #:	227
OP VOLTAGE:	138
STN/EQ :	2194.06
BACK SPAN::	406.00
DEFLECTION:	
TYPE:	TOWER
TOWER TYPE:	KR54
TOWER EXTEN:	

STRUCTURE

DWG: SH: FIG: REV:

ANCHOR SPECIAL CONST:

ANCHOR BRACKET 1: ANCHOR BRACKET 2:

REMARKS:

MA-23

GUYING:

CONDUCTORS:

LINE 005N CKT 1 LINE CKT

SIZE:

DES VOLTAGE: 110 Cv SH FIG REV

DWG:

SAG DWG: MZ00 2073

JMPR STR DWG:

DAMPERS DWG:

SPACER DWG #:

SPACER RMKS:

REMARKS:

CKT 1:
ALL DE & JS

CKT 2:

ELEVATIONS

GROUNDLINE:

SETTING:

CENTERLINE:

ERECTION

DWG:

SH: FIG: REV:

DETAIL

DWG:

SH: FIG: REV:

BOM

DWG:

SH: FIG: REV:

FOUNDATION

DWG:

SH: FIG: REV:

ANCHOR

DWG:

SH: FIG: REV:

PLAN & PROFILE

DWG:

SH: FIG: REV:

RWA

DWG:

SH: FIG: REV:

CWA

DWG:

SH: FIG: REV:

GROUND WIRE:

LINE 005N CKT 1 LINE CKT

SIZE: 5/16 GALV STEEL SH FIG REV

DWG NO: MZ0002722

SAG DWG #: MZ0001114

DAMPERS DWG #:

REMARKS:

CKT 1:
SAG NOTE: FROM 175 (2459.17) TO 284 (1900.42) SAG 5/16" STEEL GRD WIRE PER MZ0001114,
500'RS, 2516#MT. INSTALL GW ON EXISTING PEAK. SUSP.

CKT 2:

GENERAL REMARKS

2197.83 - DISTRIBUTION SECONDARY
2197.29 - TEL CABLE & OPEN WIRE

2197.57 - CL M-23 (BLACKTOP)

LINE LOCATION

PROP OWNER: CP CO

COUNTY:

REMARKS: VILLAGE OF OMER

PARCEL NO:

SECTION:

TOWNSHIP:

TOWN/RANGE:

REVISION

LETTER: B

MWO NO:

GWO:

DATE: 6/6/1977

RS NO:

DESIGNER:

NOTES:

CORRECTED LINE NAME IN REMARKS FOR RECORD (RLM)
LHW

PREPARED BY: BJC

DATE: 9/2/1964

APPROVED BY: WAC

DATE: 9/14/1964

DEPT. HEAD: BD BUGBEE

DIVISION HEAD: RG COTTRELL

LINE NO/LTR: 005N

STR ORDER: 54

STRUCT #: 227

ON 9MG

Temp °F	Tension Pounds	SPAN IN FEET					
		360'	510'	230	530	600	450'
Sag in Feet and Inches							
120	709	7'-10"	15'-9"	3'-2"	17'-0"	21'-10"	12'-2"
110	720	7'-9"	15'-7"	3'-2"	16'-9"	21'-5"	12'-0"
100	731	7'-7"	15'-2"	3'-1"	16'-5"	21'-1"	11'-10"
90	744	7'-6"	15'-0"	3'-1"	16'-2"	20'-8"	11'-7"
80	757	7'-4"	14'-9"	3'-0"	15'-11"	20'-4"	11'-6"
70	770	7'-2"	14'-5"	2'-11"	15'-7"	19'-11"	11'-5"
60	785	7'-1"	14'-2"	2'-11"	15'-4"	19'-7"	11'-1"
50	801	6'-11"	13'-11"	2'-10"	15'-0"	19'-3"	10'-10"
40	817	6'-10"	13'-7"	2'-9"	14'-8"	18'-10"	10'-7"
30	834	6'-8"	13'-5"	2'-9"	14'-5"	18'-6"	10'-4"
20	852	6'-6"	13'-1"	2'-8"	14'-1"	18'-1"	10'-1"
10	870	6'-4"	12'-10"	2'-7"	13'-10"	17'-9"	10'-0"
0	889	6'-3"	12'-6"	2'-6"	13'-6"	17'-4"	9'-9"

Temp °F	SPAN IN FEET	
	240'	370'
Sag in Feet and Inches		
120	3'-6"	8'-6"
110	3'-5"	8'-4"
100	3'-4"	8'-2"
90	3'-4"	8'-1"
80	3'-3"	7'-11"
70	3'-2"	7'-9"
60	3'-2"	7'-8"
50	3'-1"	7'-6"
40	3'-0"	7'-4"
30	2'-11"	7'-2"
20	2'-11"	7'-1"
10	2'-10"	6'-11"
0	2'-9"	6'-9"

Basis - 2612# Max. Tension at 0° + 1/2" Ice + 8# Wind + C.

60° Final Sag = 15.30
 120° Final Sag = 17.0
 4# Wind - 60° Final Tension = 833#
 32° - 1/2" Ice Final Sag = 16.8'

SECTION HEAD APP. <i>Melaron</i> 4/30/59	DATE DEM 2/19/59	CK. <i>JHAR</i>
DIVISION HEAD APP. <i>C. Evans</i> 4/30/59	FINAL SAG - TENSION DATA 110 MCM COPPER 530' R.S. 2612# M.T.	
DEPARTMENT HEAD <i>[Signature]</i> 4/30/59	CONSUMERS POWER CO. GENERAL ENGINEERING DEPARTMENT JACKSON, MICHIGAN	
NO. MZ-A2073C		SHEET 1

A-10/21/59 Added 450' column.
 B-12/22/60 Corrected 120° Final Sag
 JRH C&W
 FVK
 Added 240', 370' and 510' spans
 MA
 8/6/64



TMZ00H0T

Dwg Sheet Size
 02073 001 A

•88-2 201 30X