

October 23, 2006

Michigan Electric Transmission Company, LLC  
C/O NSI Consulting & Development, Inc.  
26657 Woodward Ave., Suite 100  
Huntington Woods, MI 48070

Attention: Executive Vice President and Chief Operating Officer

SUBJECT: Three Phase, 11,000 Delta  
Reference No: 06606555/Arenac/Arenac/Walker

REFERENCE: Amended and Restated Easement Agreement (the "Agreement") dated April 29, 2002, between Consumers Energy Company ("Consumers") and Michigan Electric Transmission Company, now Michigan Electric Transmission Company, LLC ("METC")

Pursuant to Section 7.1 of the Agreement, Consumers hereby notifies METC that Consumers intends to construct a distribution line across certain land in which METC has an interest under the Agreement. The location of the land on which said line will be constructed, and a further description of the intended use, are set forth on "Annex A", attached to this letter.

Under said Section 7.1 of the Agreement, METC must within 30 days of this notice notify Consumers, as "Initiating User," of whether or not METC approves the proposed use as a Compatible Use. If you do not notify us either way within 30 days of this notice, then, as provided in said Section 7.1, METC will be deemed to have approved the proposed use as being a Compatible Use. We would appreciate, however, receiving METC's express approval of the proposed use as being a Compatible Use as soon as possible so that we can start work without delay.

October 23, 2006

Page Two

Reference No: 06606555/Arenac/Arenac/Walker

This letter is being sent to you in duplicate. If METC agrees that the proposed use is a Compatible Use, please indicate that by signing and returning a copy of this letter to us as soon as possible, so that we can immediately proceed with construction. The other copy is for your records.

Very truly yours,

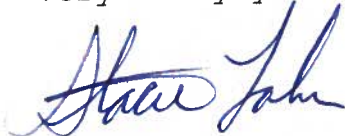

Stacie Lahr  
Consumers Energy  
One Energy Plaza  
Jackson, MI 49201

APPROVED:

MICHIGAN ELECTRIC TRANSMISSION  
COMPANY, LLC

By: \_\_\_\_\_



Date: \_\_\_\_\_

11/27/2006

Property No: 06606555/Arenac/Arenac/Walker  
Parcel ID: 00000000000000000000000000000000  
Consumers Energy  
EPT-430  
One Energy Plaza  
Jackson, MI 49201

138LN

NOTIFICATION OF PROPOSED LINE CONSTRUCTION  
REQUIRING COORDINATION WITH TRANSMISSION LINES

Send two (2) copies to:

Transmission Lines Design and Standards

Att: JUSTIN LANCASTER

Jackson, Michigan

TO BE FILLED IN BY SYSTEM OWNER / ENGINEER / CES

Headquarters Bay City

Work Order No. 06606555

Date 10-17-2006

PROPOSED DISTRIBUTION CONSTRUCTION

Sketch Attached  Yes  No

Primary:

Voltage 11,000 DELTA Phase 3

No. of Wires 3 Crossarms Per Pole 1

Wire Size 1/0 ACSR Length of Crossarms 8

Distance Below Transmission ESTIMATED AT 22 FT UNDER 138KV LINE 60 DEG. NO ICE

Skip-Span  Yes  No

Secondary:

No. of Wires Wire Size

TO BE FILLED IN BY TRANSMISSION LINES DESIGN  
AND STANDARDS OR METC

Engineering Required  Yes  No

Checked By Date

GWO No.

Other Details: SET 40' POLE 20 FEET WEST OF NEAREST OF 138 LINE. Distace measured on grade at right angle from under transmission line to new pole location is 23 feet. DISTRIBUTION WILL ATTACH ON NEW POLE AT 25 FT. CROSS UNDER 138 LINE AT 22 FT . Nearest and lowest 138 line is on west side of tower structure. Grade level distance from nearest tower located to the north of proposed crossing is 105 ft when standing under transmission line.

EXISTING DISTRIBUTION FACILITIES

Description: EXISTING 35-6 POLE - ATTACH DISTRIBUTION ARM AT 24 FT ABOVE GRADE. EXTEND NEW DISTRIBUTION LINE 90 FEET TO NEW POLE . SAG IN NEW LINE WILL BE 2.5 FEET.

LOCATION

Township ARENAC County ARENAC

Section 15 Range 05 east (55)

Transmission Line Involved IOSCO KARN  METC Line

Transmission Pole No. SPAN BETWEEN - TOWER #227 AND FIRST TOWER NORTH. loacted where line crosses US -23 in Omer, MI.

REMARKS: If the requested installation is not feasible please advise closest location for 40 foot pole on west side of this 138 line. We have a clearance problem that requires immediate correction. Thanks, Sue

Prepared By Susan Walker Date 10-17-2006  
System Planning and Performance / Electric Service

Approved By Date  
Transmission Lines Design and Standards

Approved By Date  
METC

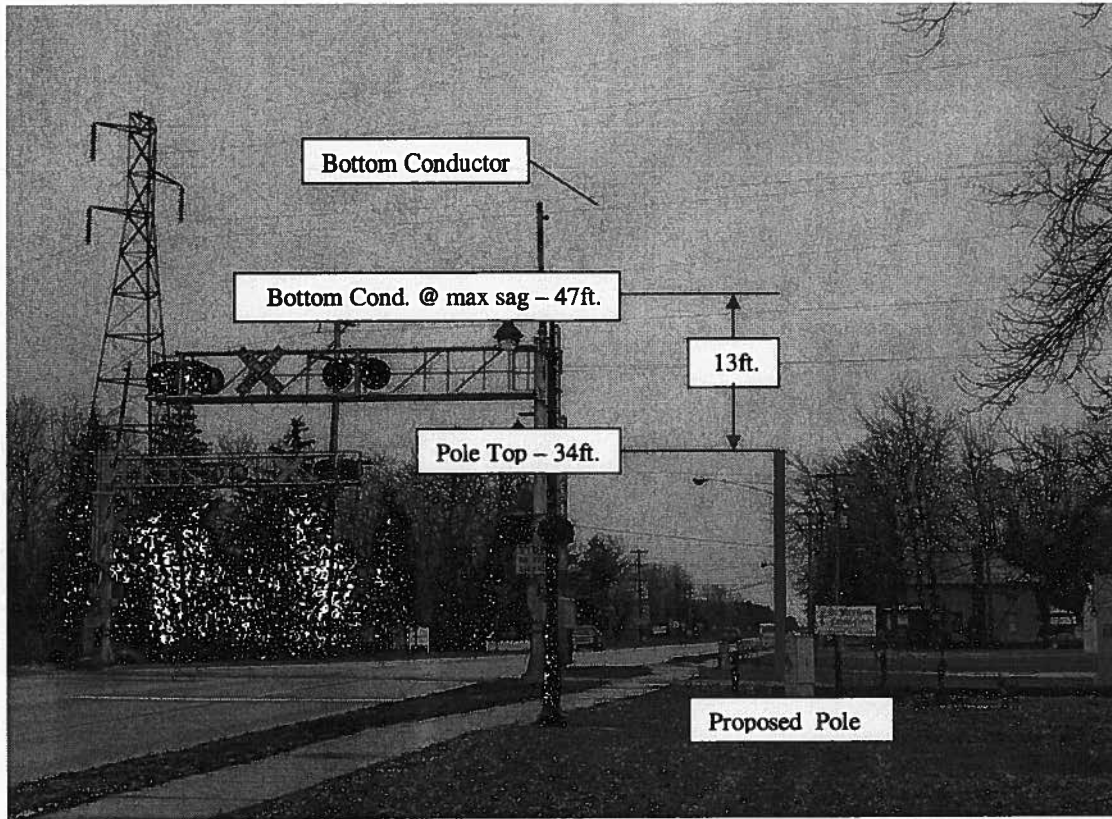

SEE PAGE 21

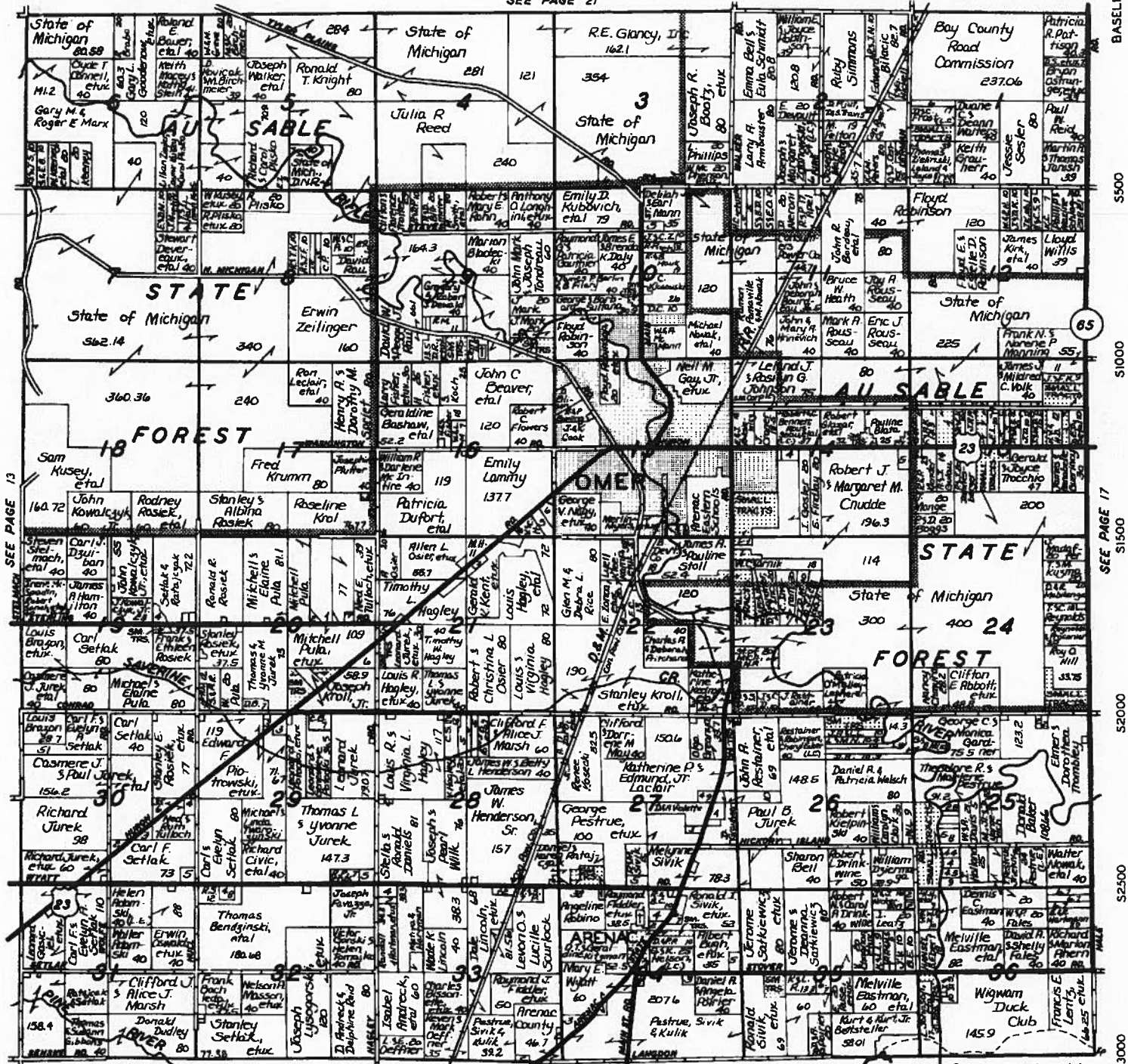

OMER CROSSING

LOCATIONS OF NEW DISTRIBUTION POLE AND LINES TO NEAREST EXISTING 138KV LINE





ARENAC CO  
ARENAC TWP  
T19 R55 SEC.15

HURON RD

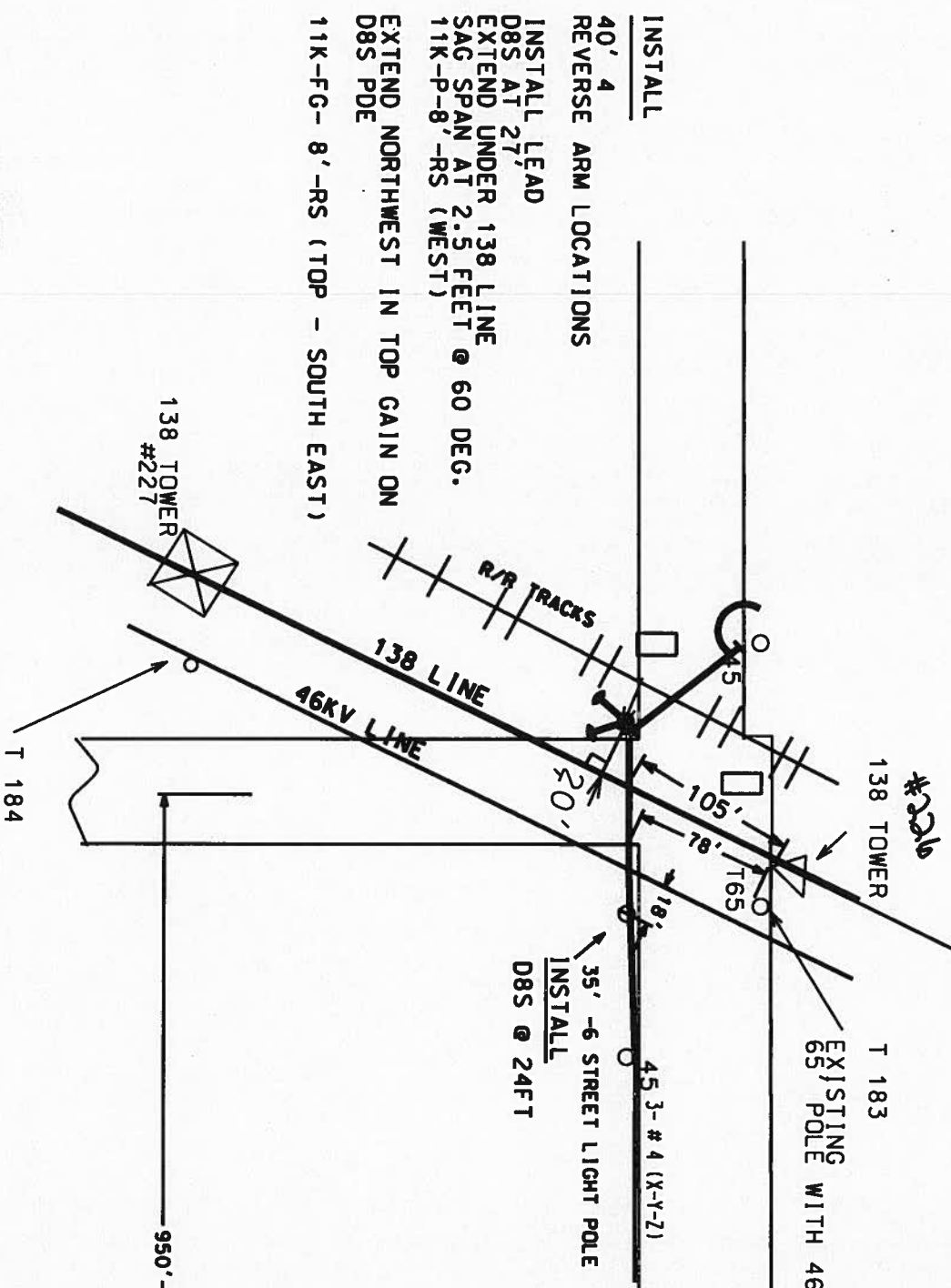
ARENAC STATE RD

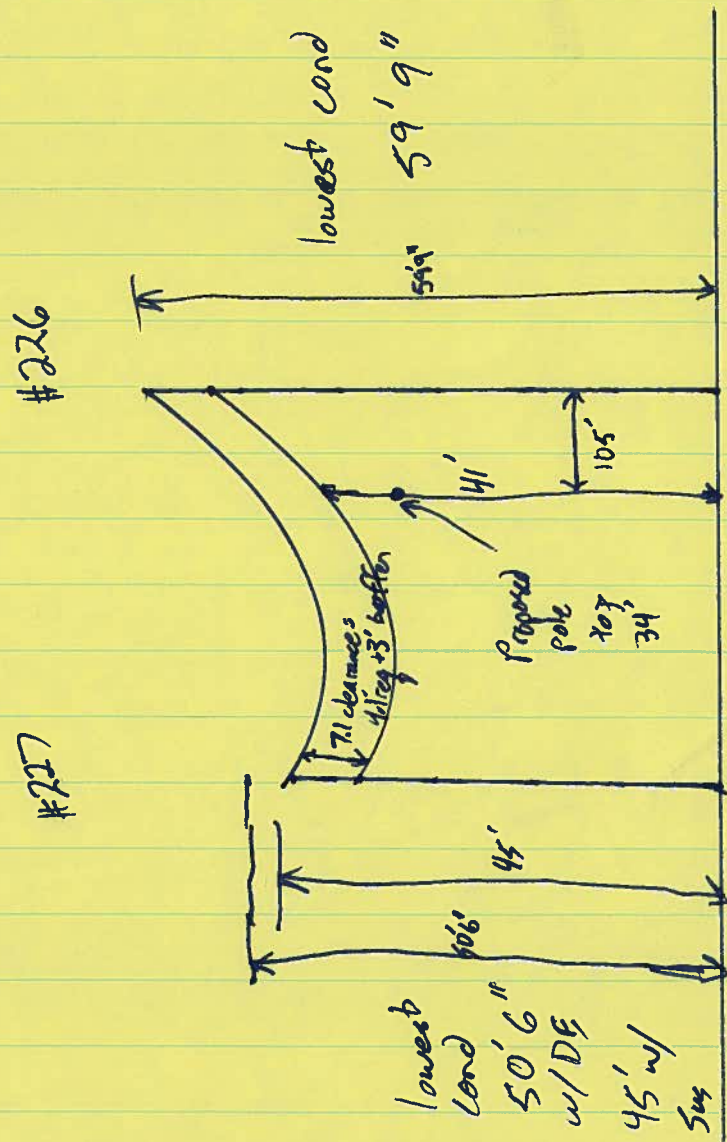
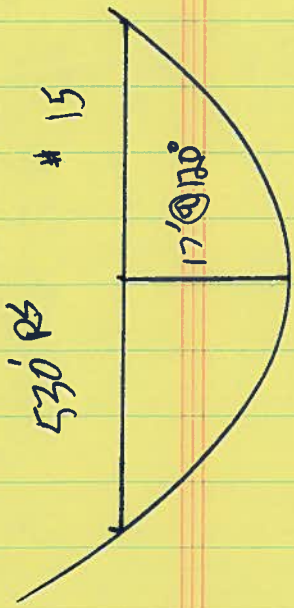



  
 10/20/06

LINE NAME : DUQUITE-TWINING

UNIQUE STRUCT #: T0008875 ORDER : 53

LINE NO/LTR:	005N
STRUCT #:	226
OP VOLTAGE:	138
STN/EQ :	2198.12
BACK SPAN::	501.00
DEFLECTION:	
TYPE:	TOWER
TOWER TYPE:	LD34
TOWER EXTEN:	

**STRUCTURE**

DWG: SH: FIG: REV:

ANCHOR SPECIAL CONST:

ANCHOR BRACKET 1: ANCHOR BRACKET 2:

REMARKS:

GUYING:

<b>CONDUCTORS:</b>						<b>ELEVATIONS</b>		
LINE	005N	CKT	1	LINE	CKT	GROUNDLINE:		
SIZE:						SETTING:		
DES VOLTAGE:						CENTERLINE:		
DWG:						<b>ERECTION</b>	DWG:	
SAG DWG:							SH:	FIG: REV:
JMPR STR DWG:						<b>DETAIL</b>	DWG:	
DAMPERS DWG:							SH:	FIG: REV:
SPACER DWG #:						<b>BOM</b>	DWG:	
SPACER RMKS:							SH:	FIG: REV:
<b>REMARKS:</b>						<b>FOUNDATION</b>	DWG:	
CKT 1:							SH:	FIG: REV:
SUSP.						<b>ANCHOR</b>	DWG:	
CKT 2:							SH:	FIG: REV:
						<b>PLAN &amp; PROFILE</b>	DWG:	
							SH:	FIG: REV:
						<b>RWA</b>	DWG:	
							SH:	FIG: REV:
						<b>CWA</b>	DWG:	
							SH:	FIG: REV:

**GROUND WIRE:**

LINE	005N	CKT	1	LINE	CKT
SIZE:	5/16 GALV STEEL				
DWG NO:	MZ0002722				
SAG DWG #:	MZ0001114				
DAMPERS DWG #:					

**REMARKS:**

CKT 1:  
SAG NOTE: FROM 175 (2459.17) TO 284 (1900.42) SAG 5/16" STEEL GRD WIRE PER MZ0001114, 500'RS, 2516#MT. INSTALL KV-93 GW PEAK PER ZM-550 (0-00' - 2 1/2'). SUSP.

CKT 2:

**GENERAL REMARKS**

REMOVE TRANSPOSITION & OLD TOWER #1224 ( KK-71) STA 2044.87

**LINE LOCATION**

PROP OWNER: CP CO  
 COUNTY:  
 REMARKS: VILLAGE OF OMER

PARCEL NO:  
 SECTION:  
 TOWNSHIP:  
 TOWN/RANGE:

**REVISION**

LETTER: B MWO NO:  
 GWO: DATE: 6/6/1977  
 RS NO: DESIGNER:  
 NOTES:  
 CORRECTED LINE NAME IN REMARKS FOR RECORD (RLM)  
 LHW

PREPARED BY: BJC  
 DATE: 9/2/1964  
 APPROVED BY: WAC  
 DATE: 9/14/1964  
 DEPT. HEAD: BD BUGBEE  
 DIVISION HEAD: RG COTTRELL

LINE NO/LTR:	005N
STR ORDER:	53
STRUCT #:	226



LINE NAME : DUQUITE-TWINING

UNIQUE STRUCT #: T0008876 ORDER : 54

LINE NO/LTR:	005N
STRUCT #:	227
OP VOLTAGE:	138
STN/EQ :	2194.06
BACK SPAN::	406.00
DEFLECTION:	
TYPE:	TOWER
TOWER TYPE:	KR54
TOWER EXTEN:	

**STRUCTURE**

DWG: SH: FIG: REV:

ANCHOR SPECIAL CONST:

ANCHOR BRACKET 1: ANCHOR BRACKET 2:

REMARKS:

MA-23

GUYING:

**CONDUCTORS:**

LINE 005N CKT 1 LINE CKT

SIZE:

DES VOLTAGE: 110 Cv SH FIG REV

DWG:

SAG DWG: MZ00 2073

JMPR STR DWG:

DAMPERS DWG:

SPACER DWG #:

SPACER RMKS:

REMARKS:

CKT 1:  
ALL DE & JS

CKT 2:

**ELEVATIONS**

GROUNDLINE:

SETTING:

CENTERLINE:

**ERECTION**

DWG:

SH: FIG: REV:

**DETAIL**

DWG:

SH: FIG: REV:

**BOM**

DWG:

SH: FIG: REV:

**FOUNDATION**

DWG:

SH: FIG: REV:

**ANCHOR**

DWG:

SH: FIG: REV:

**PLAN & PROFILE**

DWG:

SH: FIG: REV:

**RWA**

DWG:

SH: FIG: REV:

**CWA**

DWG:

SH: FIG: REV:

**GROUND WIRE:**

LINE 005N CKT 1 LINE CKT

SIZE: 5/16 GALV STEEL SH FIG REV

DWG NO: MZ0002722

SAG DWG #: MZ0001114

DAMPERS DWG #:

REMARKS:

CKT 1:  
SAG NOTE: FROM 175 (2459.17) TO 284 (1900.42) SAG 5/16" STEEL GRD WIRE PER MZ0001114,  
500'RS, 2516#MT. INSTALL GW ON EXISTING PEAK. SUSP.

CKT 2:

**GENERAL REMARKS**

2197.83 - DISTRIBUTION SECONDARY  
2197.29 - TEL CABLE & OPEN WIRE

2197.57 - CL M-23 (BLACKTOP)

**LINE LOCATION**

PROP OWNER: CP CO

COUNTY:

REMARKS: VILLAGE OF OMER

PARCEL NO:

SECTION:

TOWNSHIP:

TOWN/RANGE:

**REVISION**

LETTER: B

MWO NO:

GWO:

DATE: 6/6/1977

RS NO:

DESIGNER:

NOTES:

CORRECTED LINE NAME IN REMARKS FOR RECORD (RLM)  
LHW

PREPARED BY: BJC

DATE: 9/2/1964

APPROVED BY: WAC

DATE: 9/14/1964

DEPT. HEAD: BD BUGBEE

DIVISION HEAD: RG COTTRELL

LINE NO/LTR: 005N

STR ORDER: 54

STRUCT #: 227

ON 9MG

Temp °F	Tension Pounds	SPAN IN FEET						
		360'	510'	230	530	600	450'	
Sag in Feet and Inches								
120	709	7'-10"	15'-9"	3'-2"	17'-0"	21'-10"	12'-2"	
110	720	7'-9"	15'-7"	3'-2"	16'-9"	21'-5"	12'-0"	
100	731	7'-7"	15'-2"	3'-1"	16'-5"	21'-1"	11'-10"	
90	744	7'-6"	15'-0"	3'-1"	16'-2"	20'-8"	11'-7"	
80	757	7'-4"	14'-9"	3'-0"	15'-11"	20'-4"	11'-6"	
70	770	7'-2"	14'-5"	2'-11"	15'-7"	19'-11"	11'-5"	
60	785	7'-1"	14'-2"	2'-11"	15'-4"	19'-7"	11'-1"	
50	801	6'-11"	13'-11"	2'-10"	15'-0"	19'-3"	10'-10"	
40	817	6'-10"	13'-7"	2'-9"	14'-8"	18'-10"	10'-7"	
30	834	6'-8"	13'-5"	2'-9"	14'-5"	18'-6"	10'-4"	
20	852	6'-6"	13'-1"	2'-8"	14'-1"	18'-1"	10'-1"	
10	870	6'-4"	12'-10"	2'-7"	13'-10"	17'-9"	10'-0"	
0	889	6'-3"	12'-6"	2'-6"	13'-6"	17'-4"	9'-9"	

Temp °F	SPAN IN FEET	
	240'	370'
Sag in Feet and Inches		
120	3'-6"	8'-6"
110	3'-5"	8'-4"
100	3'-4"	8'-2"
90	3'-4"	8'-1"
80	3'-3"	7'-11"
70	3'-2"	7'-9"
60	3'-2"	7'-8"
50	3'-1"	7'-6"
40	3'-0"	7'-4"
30	2'-11"	7'-2"
20	2'-11"	7'-1"
10	2'-10"	6'-11"
0	2'-9"	6'-9"

Basis - 2612# Max. Tension  
at 0° - 1/2" Ice + 8# Wind + C.

60° Final Sag = 15.30  
120° Final Sag = 17.0  
4# Wind - 60° Final Tension = 833#  
32° - 1/2" Ice Final Sag = 16.8'

SECTION HEAD APP. <i>Helaron</i> 4/30/59	DATE DEM 2/19/59	CK. <i>JHR</i>
DIVISION HEAD APP. <i>C. Evans</i> 4/30/59	FINAL SAG - TENSION DATA 110 MCM COPPER 530' R.S. 2612# M.T.	CONSUMERS POWER CO. GENERAL ENGINEERING DEPARTMENT JACKSON, MICHIGAN
DEPARTMENT HEAD <i>[Signature]</i> 4/30/59	NO. MZ-A2073C	SHEET 1

A-10/21/59 Added 450' column.  
 B-12/22/60 Corrected 120° Final Sag  
 JRH C&W  
 FVK  
 Added 240', 370' and 510' spans  
 MA  
 8/6/64



TMZ00H0T

Dwg Sheet Size  
 02073 001 A

•88-2 201 30X